

Warning

It is always recommended to refer to the vehicle manufacturers workshop manual for specific procedures and technical data when using these tools.

Incorrect or out of phase engine timing can result in damage to valves.

It is always recommended to turn the engine slowly by hand and to recheck the camshaft and crankshaft timing positions.

Our application directory should be used as a guide only and The Tool Connection cannot be held responsible for any damage caused to your engine by using these tools.

Safety

Care should be taken when working on the engine and full protection should be worn.

The Tool Connection cannot be held responsible for any personal injury caused when using these tools.

Replacement parts can be ordered direct from The Tool Connection and not through your distributor.

LASER[®]

Timing Tool Set For Twin Cam 16v Engines



www.lasertools.co.uk



TIMING TOOL SET for 'V' ENGINES

What the kit contains:

Essential timing tools for setting and locking camshafts and crankshafts on a wide range of popular petrol and diesel engines.

Suitable for Single Overhead Cams (SOHC) and Double Overhead Cams (DOHC) often referred to as Twin Cams where multi valves are used.

Check your Timing Tool Set carefully to make sure you have all the components.

If any are missing, please contact Laser Tools on 01926 815000 -

You should have all the following components.

Item Code	Description	Oem Ref	Manufacturer
C206	Twin Camshaft Locking Tool (K16)	18G 1570	Rover
C190	Twin Camshaft Locking Tool (O Series)	18G 1524 / 12-060	Rover and Land Rover
C208	Cam belt Tensioner	4507-TJ / 0132X	Audi/VW/Citroen Peugeot
C034	Twin Cam Locking Strap	21-162B / 49JE01 054	Ford Zetec / Mazda
C035	Crankshaft TDC Locking Screw	21-210 / 49JEO1 061	Ford Zetec / Mazda
C038	Crankshaft Locking Pin 6mm	4507-TA	Citroen/Peugeot
C039	Locking Pin 10 x 80mm (2)	9041-TZ	Citroen/Peugeot
C040	Locking Pin (2)	7014-TM	Citroen/Peugeot
C043	Locking Screw M18	3242	Audi/VW
C044	Locking Plate (2)	3458	Audi/VW
C191	Balancer Shaft Locking Screw	18G 1671 / 5711 TD 07 LAG T20.100	Rover / Citroen Peugeot / Honda
C211	Twin Cam Locking Tool ECOTEC	KM 852	Vauxhall/Opel
C212	Twin Cam Locking Tool ECOTEC	KM 853	Vauxhall/Opel
C086	Camshaft Locking Pin 6.6mm (2)	18G1523 / 12-058	Rover / Land Rover
C089	Camshaft Locking Pin 5mm (2)	18G 1580 / 0178D 077 44-00 104-00	Rover / Honda / Peugeot

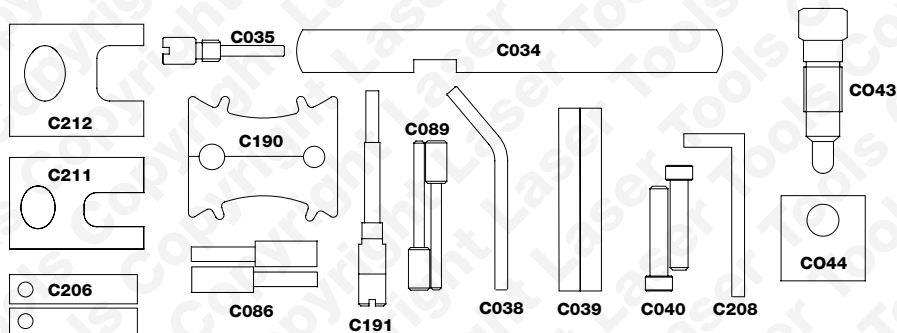

Manufacturer	Model	Year	Engine Code	Item
Audi	80/100/A4/A6/A8	1991-96	2.6 & 2.8i 'V6	C044/C043
Citroen	AX ZX Saxo Xsara Berlingo AX Gti	86-94 / 94-02	1.0/1.1/1.4	C038/C208
	Saxo Xsara		1.6 16v	C028/C038
	ZX Xantia XM	1992-01	2.0 16v	C040
	AX 1.4D	1989-94	1.4D	C038/C208
Ford	Saxo AX Xsara	1994-02	1.5D	C038/C208
	Fiesta	1995-97	1.25/1.4	C034/C035
	Fiesta Puma	1997-02	1.25/1.4/1.6	C034/C035
	Fiesta Escort Orion	1991-01	1.6i/XR2i/RS 1800 16v	C034
	Focus Mondeo Cougar	1998-02	1.6/1.8/2.0	C034
	Puma	1997-02	1.6/1.7	C035
Honda	Accord	1990-96	1.8/2.0/2.2	C191
	Accord/Aerodeck/Coupe	1993-02	1.8/2.0/2.2 VTEC	C191
	Accord Prelude	1987-92	2.0 16v	C089
	Accord Coupe/Prelude	1987-02	2.0	C191
	Accord Prelude	1992-96	2.3i	C191
	Prelude Accord Type R	1993-02	2.2 V-TEC	C191
Land Rover	Shuttle	1995-02	2.2i/2.3i	C191
	Discovery	1993-97	MPI 2.0 16v	C190/C086
	Freelander	1997-00	2.0 TD	C086
Mazda	121	1995-01	1.25	C034
	Peugeot	206	1998-02	1.1/1.4/1.6
	306	1995-98	1.8 16v	C039
	306	1999-02	1.8 16v	C039
	306 /406	1995-98	2.0 16v	C039
	Rover	111 114 211 214	1995-99	
	214/216 Cabrio Coupe 218 414/416 45 416 Tourier 75	1995-99	16v	C206
	214/216 25 216 Cabrio Coupe 218 414/416 45 416 Tourer 75	1998-02	1.4/1.6/1.8	C206
	216 416 Gti	1990-95	16v	C089
	200 218 BRM 25 MGF	1995-02	1.8 Vi VVC	C206
	220 420 820	1986-92	16v/Turbo	C086
	220 420i 420 820 Vitesse	1991-99	2.0 16v/Turbo	C190
	618 620	1993-99	SOHC	C191
	620	1994-99	Ti	C086
	623	1993-99		C191
	MGF	1995-02	1.8	C206
	115D	1995-98		C038
	Maestro D/Van Montego D	1986-95	2.0 Turbo	C086
	220D 25D 45D	1995-02	2.0 Turbo	C086
	420 620	1995-99	D Turbo	C086
	Vauxhall/Opel	Corsa C, Astra G Vectra Zafira	1995-02	1.4/1.6/1.8 16v
Astra G Vectra		1995-02	2.0 16v	C211
Astra G Zafira		2000-02	2.0 Turbo	C212
Omega-B Frontera B Sintra A1995-02		2.2 16v	M	C212
Volkswagen	Passat	1996-02	2.8 30v	C043
	Passat	1998-02	2.5 V6 Tdi	C043