

6495 - Precautions

- The stand must only be used on a smooth, flat, level surface.
- Mounting the motorcycle on the stand is a two-man operation. Your assistant must support the weight of the motorcycle in the upright position as the stand is being adjusted and then fitted.
- When using the stand on the front wheel, the rear wheel must be secured on an additional stand or wheel chock.
- Motorcycles are heavy, and are easily tipped over. Make sure that the motorcycle is secured in the upright position by an assistant when engaging the stand. The Tool Connection cannot be held responsible for any damage or injury due to incorrect use of the stand.

Our products are designed to be used correctly and with care for the purpose for which they are intended. No liability is accepted by the Tool Connection for incorrect use of any of our products, and the Tool Connection cannot be held responsible for any damage to personnel, property or equipment when using the tools. Incorrect use will also invalidate the warranty.

If applicable, the applications database and any instructional information provided has been designed to offer general guidance for a particular tool's use and while all attention is given to the accuracy of the data no project should be attempted without referring first to the manufacturer's technical documentation (workshop or instruction manual) or the use of a recognised authority such as Autodata.

It is our policy to continually improve our products and thus we reserve the right to alter specifications and components without prior notice. It is the responsibility of the user to ensure the suitability of the tools and information prior to their use.



Safety First. Be Protected.

Guarantee

If this product fails through faulty materials or workmanship, contact our service department direct on: **+44 (0) 1926 818186**. Normal wear and tear are excluded as are consumable items and abuse.



Distributed by The Tool Connection Ltd

Kineton Road, Southam, Warwickshire CV47 0DR
T +44 (0) 1926 815000 F +44 (0) 1926 815888
info@toolconnection.co.uk www.toolconnection.co.uk



5 018341 064952 >

LASER[®]

6495

Motorcycle Stand Front/Rear

Instructions



6495 - Motorcycle Stand

Combination motorcycle stand for front or rear wheels. Convert from front to rear stand by simply changing the handle and the support adaptors. The height is adjustable and the stand has a load capacity of 200kg. The four wheels and strong 1.8mm tubular steel construction give excellent stability.

Components

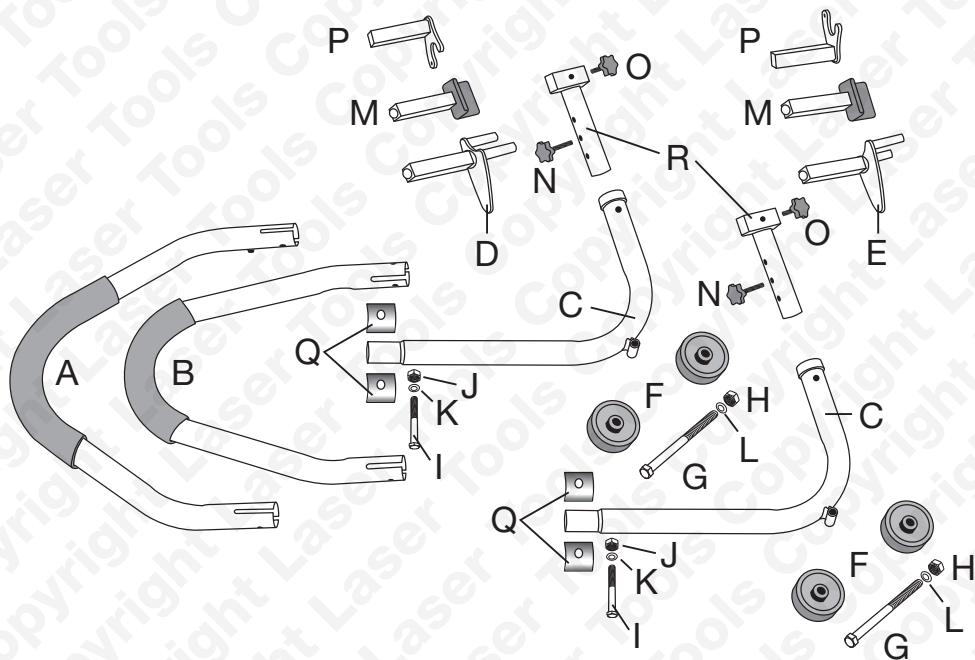

Ref.	Description	Qty	Ref.	Description	Qty
A	Lift handle (wide) for rear wheel use	1	J	Nut M10	2
B	Lift handle (narrow) for front wheel use	1	K	Washer M10	4
C	Vertical support arms	2	L	Washer M12	4
D	Adaptor: Right front fork support	1	M	Adaptor: Rear L-Saddle	2
E	Adaptor: Left front fork support	1	N	Hand Bolt M10	2
F	Wheels	4	O	Hand Bolt M8	2
G	Bolt M12 x 125mm	2	P	Adaptor: Rear stand bobbin support	2
H	Nut M12	2	Q	Thrust pads	4
I	Bolt M10 x 52mm	2	R	Vertical support adaptor mounts	2

Instructions

