

Part No. 8942

LASER[®]

Flywheel Locking Tool

for HEV & PHEV Hyundai & Kia

Instructions



www.lasertools.co.uk

Introduction

Designed specifically for the hybrid and plugin hybrid vehicles from Hyundai and Kia. The Laser 8942 locks into the back of the flywheel/drive plate from underneath the vehicle. The flywheel/drive plate on the vehicles listed does not have a ring gear, so the 8942 specially shaped pawl is designed to lock into the back of the drive plate to lock the engine and allow removal and re-torquing of the crankshaft pulley.

- Applications include: HEV & PHEV – Hyundai Tucson, Sante Fe; Kia Sportage, Sorento.
- Lock the crankshaft to allow easy removal and refitting of the crankshaft pulley.
- Specially shaped locking pawl locks in to the back of the drive plate.
- Equivalent to OEM ref. 09231 3D200 for applications listed.

Components

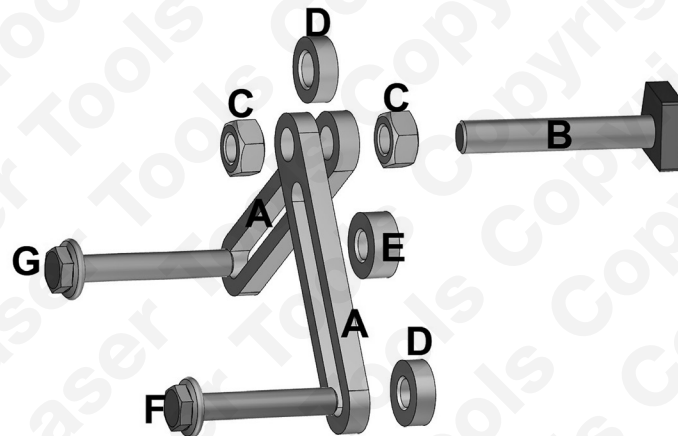

Ref.	Description	OEM ref.
A	2 x Mounting Frame Bars	09231 3D200
B	M12 Centre Bolt with Locking Quadrant	
C	2 x M12 x 1.75mm Nuts	
D	2 x 7.5mm Spacers	
E	1 x 10mm Spacer	
F	1 x M10 x 50mm Bolt + Washer	
G	1 x M10 x 60mm Bolt + Washer	

Instructions

The information given here is for reference only. Laser Tools recommends the use of manufacturer data or Autodata. Laser Tools cannot be held responsible for damage to engine or personnel whilst using this tool kit.



ALWAYS REFER TO MANUFACTURER SPECIFIC DATA AND INSTRUCTIONS.

Warning: Hybrid drive vehicles (including PHEV & MHEV):

Where the vehicle is a hybrid electric vehicle there may be a risk of injury due to electric shock. Please ensure all manufacturers' safety recommendations are followed at all times including any relevant HV disconnection processes and the use of appropriate PPE as specified by the vehicle manufacturer. No liability is accepted by the Tool Connection for injury or shock to personnel, property or equipment, however caused.

Instructions

Assemble the flywheel locking tool as shown in figure 1.

FIG:1

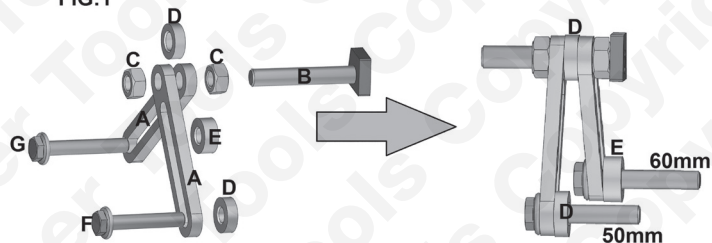

Instructions

Fitting the flywheel tool

- Remove the following components:
Lower engine tray
Small plastic cover on lower side of the flywheel/drive plate housing
- Align the drive plate/flywheel as shown in figure 2.

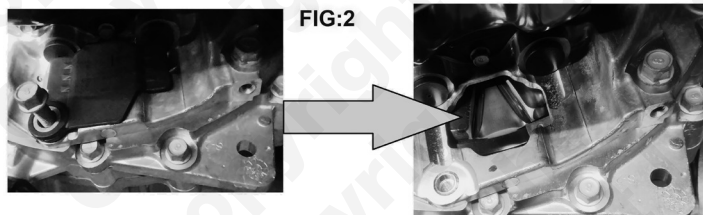

- Fit the locking tool as shown in figure 3 and tighten all nuts and bolts ensuring the locking quadrant is in contact with the drive flange/flywheel.
- **IMPORTANT** - Ensure bolts (F) and (G) are used in the locations shown.

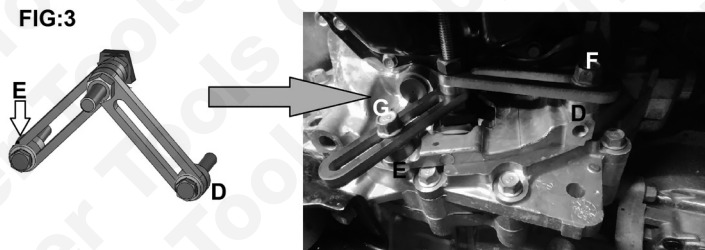

N.B. Observe manufacturers tightening sequence and torques for the front cover bolts.

Safety Warnings - please read

- Wear eye and hand protection when using this tool kit.
- Always carefully clean the tool components after each use.
- Keep the tool components safe and tidy in the supplied case.
- Do not use the kit for any purpose other than for which it is designed.



Safety First. Be Protected.

Our products are designed to be used correctly and with care for the purpose for which they are intended. No liability is accepted by the Tool Connection for incorrect use of any of our products, and the Tool Connection cannot be held responsible for any damage to personnel, property or equipment when using the tools. Incorrect use will also invalidate the warranty.

If applicable, the applications database and any instructional information provided has been designed to offer general guidance for a particular tool's use and while all attention is given to the accuracy of the data no project should be attempted without referring first to the manufacturer's technical documentation (workshop or instruction manual) or the use of a recognised authority such as Autodata.

It is our policy to continually improve our products and thus we reserve the right to alter specifications and components without prior notice. It is the responsibility of the user to ensure the suitability of the tools and information prior to their use.



8942_Instructions_V2



www.lasertools.co.uk

Guarantee

If this product fails through faulty materials or workmanship, contact our service department direct on: +44 (0) 1926 818186. Normal wear and tear are excluded as are consumable items and abuse.



Distributed by The Tool Connection Ltd
Kington Road, Southern, Warwickshire CV47 0DR
T +44 (0) 1926 815000 F +44 (0) 1926 815889
info@toolconnection.co.uk www.toolconnection.co.uk

www.lasertools.co.uk