

Incorrect or out of phase engine timing can result in damage to the valves. The Tool Connection cannot be held responsible for any damage caused by using these tools in anyway.

Safety Precautions – Please read

- Disconnect the battery earth leads (check radio code is available)
- Remove spark or glow plugs to make the engine turn easier
- Do not use cleaning fluids on belts, sprockets or rollers
- Always make a note of the route of the auxiliary drive belt before removal
- Turn the engine in the normal direction (clockwise unless stated otherwise)
- Do not turn the camshaft, crankshaft or diesel injection pump once the timing chain has been removed (unless specifically stated)
- Do not use the timing chain to lock the engine when slackening or tightening crankshaft pulley bolts
- Do not turn the crankshaft or camshaft when the timing belt/chain has been removed
- Mark the direction of the chain before removing
- It is always recommended to turn the engine slowly, by hand and to re-check the camshaft and crankshaft timing positions.
- Crankshafts and Camshafts may only be turned with the chain drive mechanism fully installed.
- Do not turn crankshaft via camshaft or other gears
- Check the diesel injection pump timing after replacing the chain
- Observe all tightening torques
- Always refer to the vehicle manufacturer's service manual or a suitable proprietary instruction book
- Incorrect or out of phase engine timing can result in damage to the valves
- It is always recommended to turn the engine slowly, by hand, and to re-check the camshaft and crankshaft timing positions

LASER®

Part No. 3471

Engine Timing Tools Fiat 1.9D I Turbo Diesel



www.lasertools.co.uk

Guarantee

Distributed by The Tool Connection Ltd
Kington Road, Southam, Warwickshire CV47 0DR
T +44 (0) 1926 815000 F +44 (0) 1926 815888
info@toolconnection.co.uk www.toolconnection.co.uk

If this product fails through faulty materials or workmanship, contact our service department direct on: **+44 (0) 1926 818186**. Normal wear and tear are excluded as are consumable items and abuse.

www.lasertools.co.uk

www.lasertools.co.uk

Plan Layout

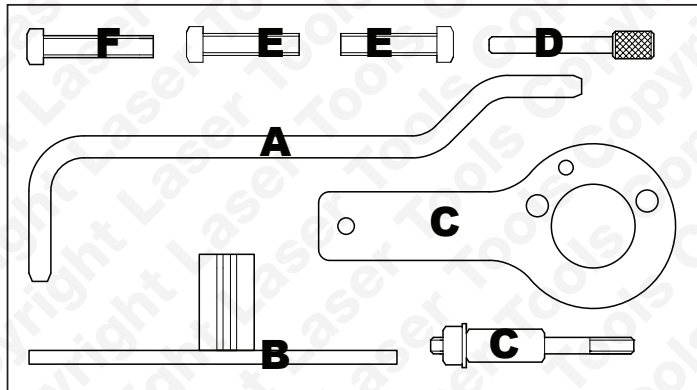
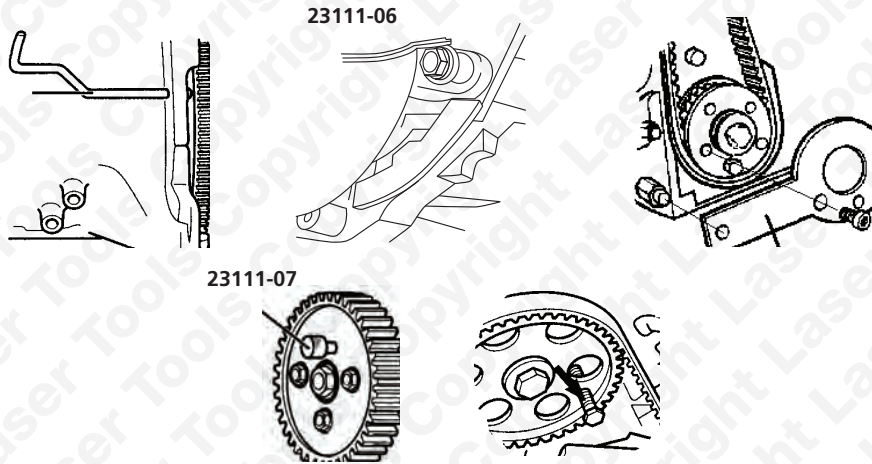

Ref	Code	Oem Code	Description
A	C062	1 860 863 000	Cranked Setting Pin 8mm
B	C148	1 860 898 000	Flywheel Locking Tool
C	C150	1 860 905 000 1 860 905 010	Crankshaft Timing Tool
D	C091	1 860 965 000	Timing Pump Locking Pin
E	C063		M8 x 35mm Locking Screw
F	C064		M8 x 40mm Locking Screw

Applications

The application list for this product has been compiled cross referencing the OEM Tool Code with the Component Code.

In most cases the tools are specific to this type of engine and are necessary for Cam belt or chain maintenance.

If the engine has been identified as an interference engine valve to piston damage will occur if the engine is run with a broken Cam belt.

A compression check of all cylinders should be performed before removing the cylinder head.

Always consult a suitable work shop manual before attempting to change the Cam belt or Chain.

The use of these engine timing tools is purely down to the user's discretion and Tool Connection cannot be held responsible for any damage caused what so ever.

ALWAYS USE A REPUTABLE WORKSHOP MANUAL

Manufacturer	Model	Style
Fiat	Brava Bravo Marea Marea Weekend	1.9D TD (96-)
	Ulysee Scudo	1.9D TD (94-)
	Ulysee	2.1 12v TD (96-)
	Marea Marea Weekend	2.4D Turbo (96-)
Citroën	XM	2.1 2.2D TD
	Xantia Dispatch Jumpy Synergie Evasion	2.1D Turbo
Peugeot	406 806 Expert Boxer	1.9D TD 2.1D Turbo (94-)