

# LASER<sup>®</sup>

Part No. 4556

## Instructions

### Engine Timing Tool Kit

Audi 2.4, 3.2L

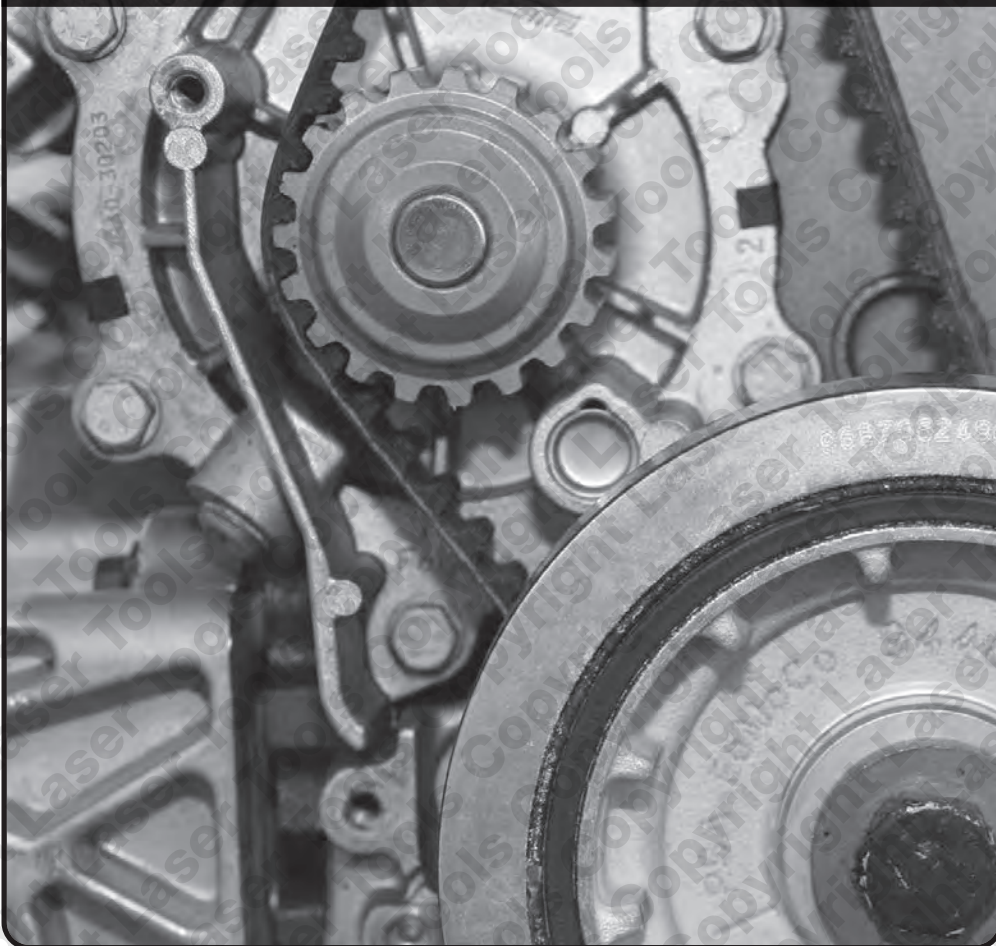

Please refer to [www.lasertools.co.uk/toolpoint](http://www.lasertools.co.uk/toolpoint)  
to check the most up to date product applications.

**[www.lasertools.co.uk](http://www.lasertools.co.uk)**

The 4556 kit has the essential timing tools required for the 2.4 and 3.2 V6 FSi engines as well as the 5 cylinder 2.5 FSi petrol engines found in the Audi range.

Components

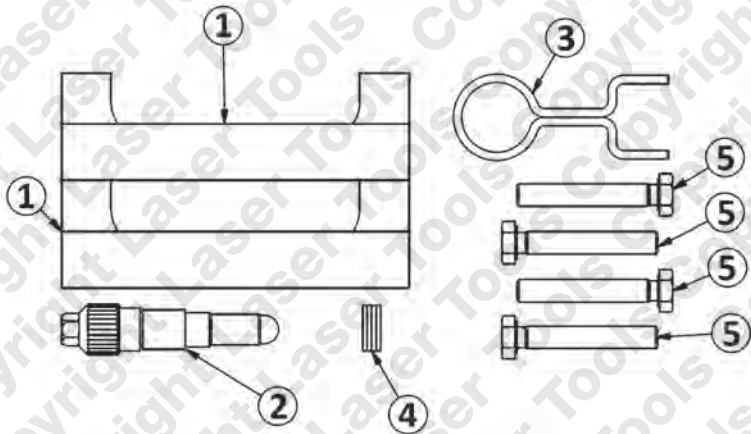

Ref.	Code	OEM Code	Description
1	C356	T40070	Camshaft Locking bridges
2	C357	T40069	Crankshaft Locking Pin
3	C358	T40071	Chain Tensioner Clip
4			Washer for 1
5			Bolts for 1

Instructions

The following instructions are for guidance only. Please refer to OEM derived data such as the vehicle manufacturers' own data or Autodata.

The use of this engine timing tool kit is purely down to the user's discretion and The Tool Connection Ltd. cannot be held responsible for any damage caused whatsoever.

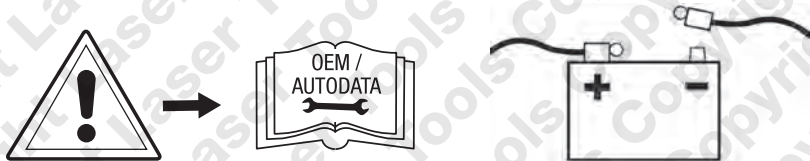

# Instructions

**NOTE:** Transmission, engine may need to be removed. The timing chains are located at the rear of the engine.

**Instructions for use:** For all engines fit the cam bridges (1) with the holes in the cam shaft positioned uppermost.

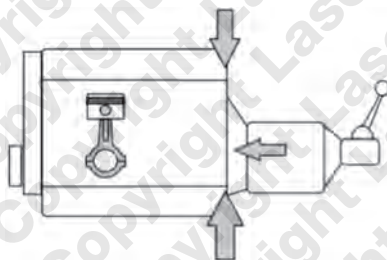

## Remove

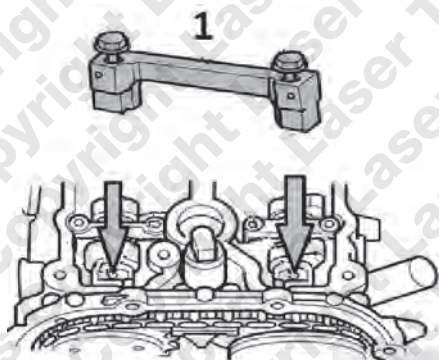

**Crankshaft timing pin**  
- 2.5lt, 5 cylinder.

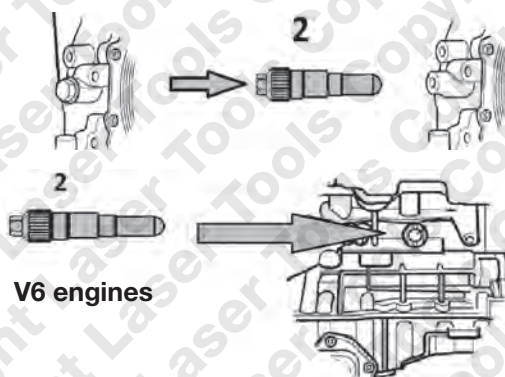

**V6 engines**

# Applications

Make, Model, Year			Engine Codes	
Audi	A4/Quattro/Cabrio	2004 - 2009	2.4 FSI BDW	3.2 FSI
	A6/Quattro/Allroad	2004 - 2009		AUK
	A8	2005 - 2010		BKH BPK

Always refer to the website for most up to date applications: [www.lasertools.co.uk/product/4556](http://www.lasertools.co.uk/product/4556)

## Safety Warnings - please read

- If the engine has been identified as an Interference engine, damage to the engine will occur if the timing belt has been damaged. A compression check of all the cylinders should be taken before the cylinder head (s) are removed.
- Do not turn crankshaft or camshaft when the timing belt/chain has been removed.
- To make turning the engine easier, remove the spark plugs/glow plugs or injectors.
- Observe all tightening torques.
- Do not turn the engine using the camshaft or any other sprocket.
- Disconnect the battery earth lead (check Radio code is available).
- Do not use cleaning fluids on belts, sprockets or rollers.
- Some toothed timing belts are not interchangeable. Check the replacement belt has the correct tooth profile.
- Always mark the belt with the direction of running before removal.
- Do not lever or force the belt onto its sprockets.
- Do not use timing pins to lock the engine when slackening or tightening the crankshaft pulley bolts.
- ALWAYS REFER TO A REPUTABLE MANUFACTURERS WORKSHOP MANUAL.

Our products are designed to be used correctly and with care for the purpose for which they are intended. No liability is accepted by the Tool Connection for incorrect use of any of our products, and the Tool Connection cannot be held responsible for any damage to personnel, property or equipment when using the tools. Incorrect use will also invalidate the warranty.

If applicable, the applications database and any instructional information provided has been designed to offer general guidance for a particular tool's use and while all attention is given to the accuracy of the data no project should be attempted without referring first to the manufacturer's technical documentation (workshop or instruction manual) or the use of a recognised authority such as Autodata.

It is our policy to continually improve our products and thus we reserve the right to alter specifications and components without prior notice. It is the responsibility of the user to ensure the suitability of the tools and information prior to their use.



4556\_Instructions\_V2



When you have finished with this tool please recycle it

[www.lasertools.co.uk](http://www.lasertools.co.uk)



Distributed by The Tool Connection Ltd

Kineton Road, Southam, Warwickshire CV47 0DR  
T +44 (0) 1926 815000 F +44 (0) 1926 815888  
[info@toolconnection.co.uk](mailto:info@toolconnection.co.uk) [www.toolconnection.co.uk](http://www.toolconnection.co.uk)

### Guarantee

If this product fails through faulty materials or workmanship, contact our service department direct on: **+44 (0) 1926 818186**. Normal wear and tear are excluded as are consumable items and abuse.

[www.lasertools.co.uk](http://www.lasertools.co.uk)