



Safety First. Be Protected.

5788

LASER[®]

Wheel Bearing Supports

Instructions



Guarantee

If this product fails through faulty materials or workmanship, contact our service department direct on: **+44 (0) 1926 816186**. Normal wear and tear are excluded as are consumable items and abuse.



Distributed by The Tool Connection Ltd

Kinerton Road, Southam, Warwickshire CV47 0DR
T +44 (0) 1926 815000 F +44 (0) 1926 815888
info@toolconnection.co.uk www.toolconnection.co.uk



Two dummy drive shafts to allow most light vehicles to be placed back on their wheels and maneuvered without their drive shafts during prolonged front end work.

Beware of ABS sensors on newer vehicles

DO NOT TOW VEHICLE ON PUBLIC HIGHWAY USING THIS PRODUCT

www.lasertools.co.uk

www.lasertools.co.uk

Dummy Drive Shaft | Temporary Wheel Bearing Support

During long term front end work on front wheel drive vehicles, it is sometimes necessary to remove the vehicles drive shafts.

Due to the lead times involved with certain sub contracted overhaul procedures, the vehicle may be required to be 'moth balled' for a time with the job half done.

If the vehicle has had its drive shafts removed and must be moved to a suitable place for storage, it should not be placed back on its wheels with the drive shaft left out as the weight of the vehicle could force the wheel bearing races to separate so damaging the bearings.

This means that the vehicle must be left either on stands or a ramp, rendering the ramp useless until the job is completed.

It is for this reason that a set of 'dummy drive shafts' or wheel bearing supports has been designed to insert in place of the driveshaft.

Once the tool is inserted the vehicle can be placed back on its wheels and rolled free of the ramp to free up space in the garage.

This kit is designed to allow the vehicle to be pushed to a place of storage. The kit must not be used to allow the vehicle to be towed on the public hi-way.

Always ensure the components do not touch or press against any ABS sensors.

Each support is made up of a 5 piece set which includes two bevelled bushes for either side of the wheel bearing (bearing and hub), a centre lead screw & two matching support nuts.

This kit has been developed to suit as many wheel bearing variants as possible. Please consult attached bush dimensions to determine suitability for intended use.

THESE TOOLS ARE SUPPLIED IN PAIRS TO SUPPORT BOTH BEARINGS!

Contents

ID	Dimensions	Description
A	Smallest dia. = 20mm largest dia. = 44mm taper length = 20mm	Bevelled Bush (outer) (2)
B	Smallest dia. = 20mm largest dia. = 60mm taper length = 1.75mm	Bevelled Bush (inner) (2)
C	180mm long	M18 x 2.5 set screw (2)
D		M18 x 2.5 nut (4)

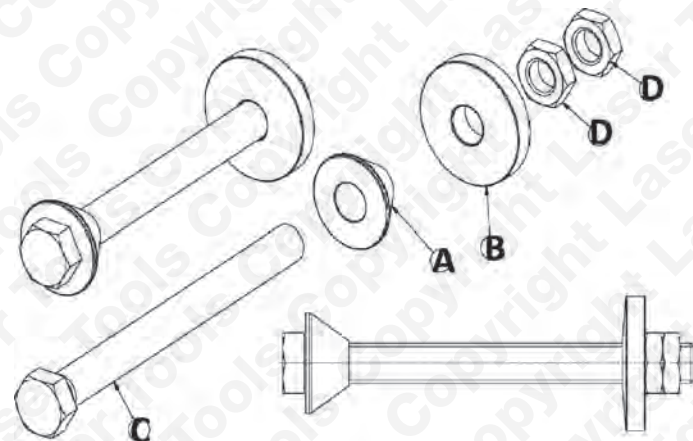

Instructions

Before fitting the dummy drive shafts first check that component (A) fits into the outer drive flange hole and that component (B) contacts the inner bearing component of the inside of the bearing.

Insert component (C) into component (A) as shown above and insert them into front drive flange.

Fit component (B) onto the inner end of component (C) and fit 2 of component (D).

Tighten the lock nuts to no more than 30Nm (enough to hold the bearings in place).

