

LASER[®]

Part No. 6813

Camshaft Locking Tool

For Mercedes-Benz

Instructions



www.lasertools.co.uk

Introduction

Camshaft locking tool kit for Mercedes-Benz M651 post 2012. Designed specifically to lock the camshaft in their timed position when replacing the timing chain or checking the camshaft timing. Designed to be bolted down for added security.

- For M651 engines, including engines used in Mercedes-Benz hybrids.
- Designed specifically to lock the camshaft in their timed position when replacing the timing chain or checking the camshaft timing. Designed to be bolted down for added security.
- Equivalent to OEM 65189094000.
- Use with Laser Part No. 6896 for complete engine timing solution.
- Made in Sheffield.

Components

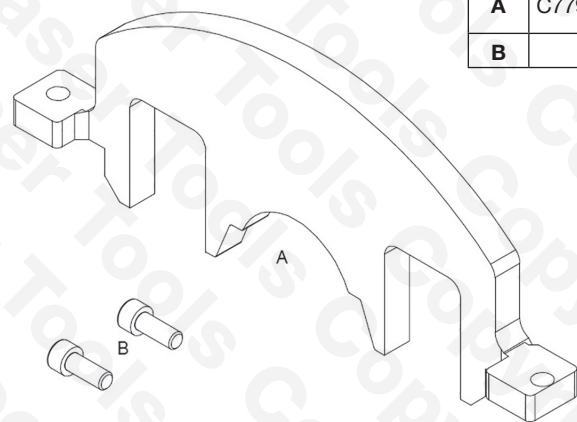

| Ref. | Comp. Code. | OEM Ref. | Description |
|------|-------------|--------------------------------------|--------------------------|
| A | C779 | 651 589 09 40 00 651 589 01 40 00 | Camshaft Locking Tool |
| B | | | Bolts |

The following instructions are for guidance only. Please refer to OEM derived data such as the vehicles manufactures own data or Autodata. The use of this engine timing tool kit is purely down to the user's discretion and Laser Tools cannot be held responsible for any damage caused what so ever.



Applications

| Make, Model, Year | | | Engine Codes | |
|-------------------|--------------|-------------|--------------|---------------|
| Mercedes-Benz | A-Class | 2012 -2018 | 1.8 | 651.958 |
| | B-Class | 2012 - 2019 | 651.901 | 651.959 |
| | C-Class | 2009 - 2018 | 2.1 | 651.960 |
| | CLA Coupe | 2013 - 2019 | 651.900 | 651.961 |
| | CLS | 2011 - 2018 | 651.910 | 651.980 |
| | E-Class | 2009 - 2016 | 651.911 | 2.2 CRD |
| | GLA | 2014 - 2020 | 651.912 | 651.925 (ENE) |
| | GLC | 2015 - 2019 | 651.913 | |
| | GLE | 2015 - 2019 | 651.916 | |
| | GLK | 2008 - 2015 | 651.921 | |
| | M-Class | 2011 - 2015 | 651.922 | |
| | S-Class | 2010 - 2017 | 651.924 | |
| | SLC | 2016 - 2017 | 651.925 | |
| | SLK | 2012 - 2016 | 651.930 | |
| | Sprinter | 2009 - on | 651.940 | |
| Jeep | Vito/Viano | 2010 - 2015 | 651.950 | |
| | Vito/V-Class | 2014 - on | 651.955 | |
| | Compass | 2010 - 2015 | 651.956 | |
| | Patriot | 2010 - 2013 | 651.957 | |

Always refer to the website for most up to date applications:
www.lasertools.co.uk/product/6813

Instructions

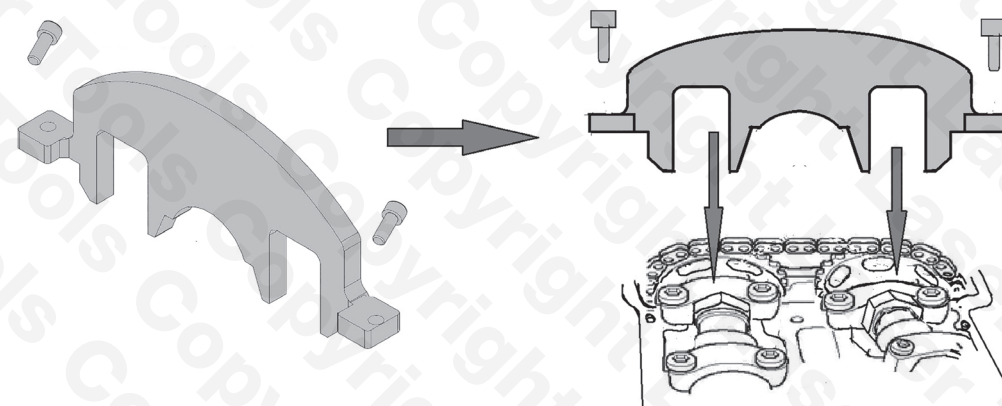

Our products are designed to be used correctly and with care for the purpose for which they are intended. No liability is accepted by the Tool Connection for incorrect use of any of our products, and the Tool Connection cannot be held responsible for any damage to personnel, property or equipment when using the tools. Incorrect use will also invalidate the warranty.

If applicable, the applications database and any instructional information provided has been designed to offer general guidance for a particular tool's use and while all attention is given to the accuracy of the data no project should be attempted without referring first to the manufacturer's technical documentation (workshop or instruction manual) or the use of a recognised authority such as Autodata.

It is our policy to continually improve our products and thus we reserve the right to alter specifications and components without prior notice. It is the responsibility of the user to ensure the suitability of the tools and information prior to their use.



Safety First. Be Protected.



5 018341 068134 >

6813_Instructions_V2



When you have finished with
this bottle please recycle it

www.lasertools.co.uk



Distributed by The Tool Connection Ltd

Kington Road, Southam, Warwickshire CV47 0DR

T +44 (0) 1926 815000 F +44 (0) 1926 815888

info@toolconnection.co.uk www.toolconnection.co.uk

Guarantee

If this product fails through faulty materials or workmanship, contact our service department direct on: **+44 (0) 1926 818186**. Normal wear and tear are excluded as are consumable items and abuse.

www.lasertools.co.uk