

LASER[®]

Part No. 4076

Instructions

Engine Timing Tool Kit

Renault & Vauxhall/Opel

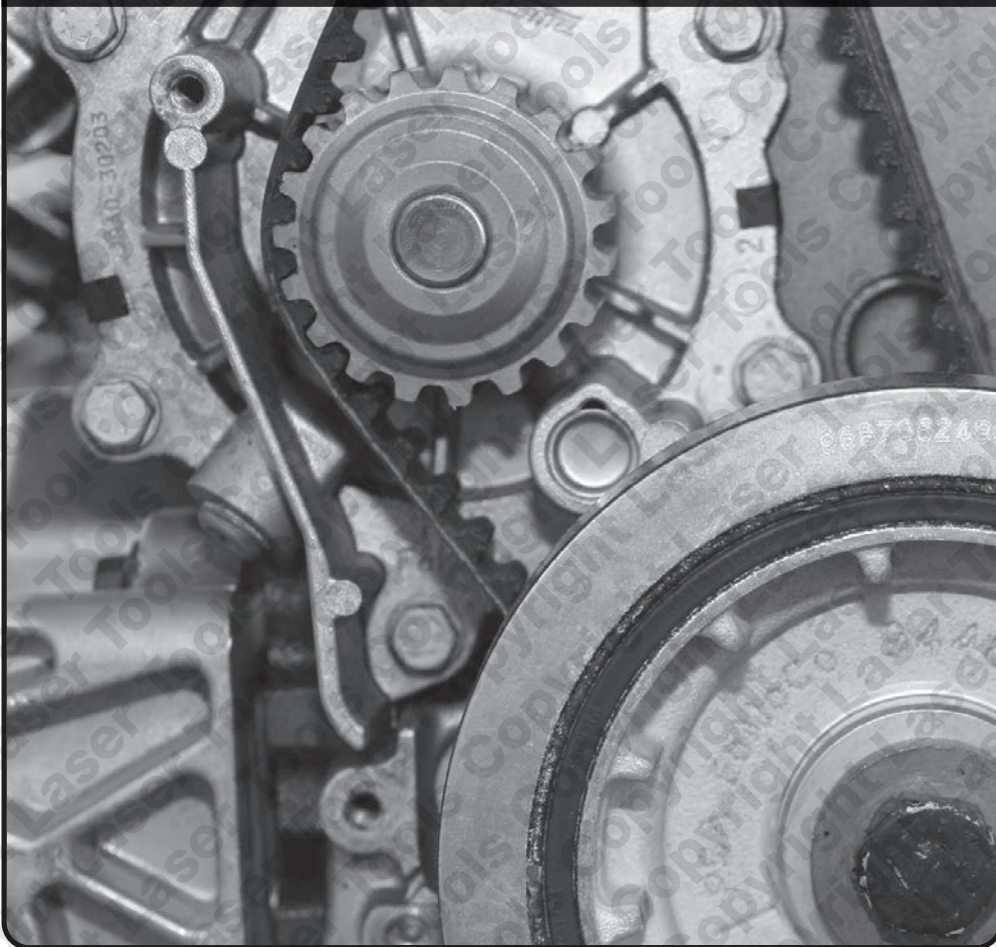

*Please refer to www.lasertools.co.uk/toolpoint
to check the most up to date product applications.*

www.lasertools.co.uk

Components

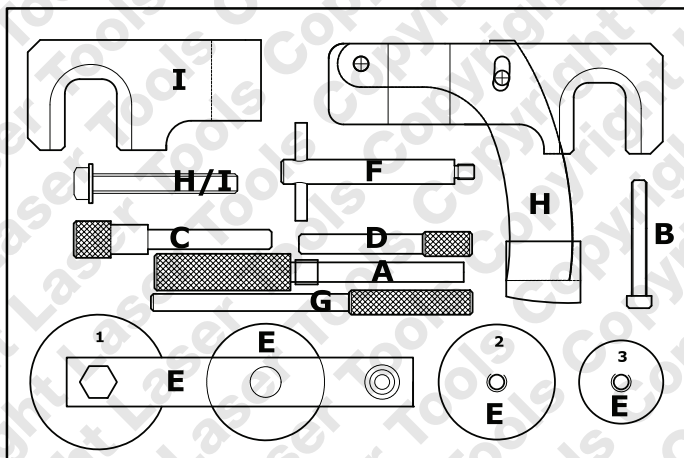

Ref.	Code	OEM Code	Description
A	C037	MOT 1489	Crankshaft Timing Pin
B	C067		M6 X 30mm Tensioning Screw
C	C099	MOT 1054	Flywheel Locking Pin
D	C101	MOT 1430	Camshaft Timing Pin
E	C281	MOT 1543	Tension Pre-Setting Tool
F	C182	MOT 1538	Hi Pressure Fuel Pump Pulley Locking Pin
G	C179	MOT 1536	Flywheel Setting Pin
H	C180	MOT 1537	Camshaft Locking Tool - Exhaust
I	C181	MOT 1534	Camshaft Locking Tool - Inlet

Applications

Make, Model, Year			Engine Codes			
Dacia	Dokker	2012 - 2018	1,5 dCi	K9K 732	F9Q 716	G9T 700
	Duster	2010 - 2018	K9K 612	K9K 734	F9Q 717	G9T 702
	Lodgy	2012 - 2018	K9K 626	K9K 740	F9Q 718	G9T 703
	Logan	2005 - 2018	K9K 656	K9K 750	F9Q 720	G9T 706
	Sandero	2008 - 2018	K9K 658	K9K 752	F9Q 722	G9T 707
Nissan	Almera	2002- 2006	K9K 666	K9K 760	F9Q 730	G9T 710
	Cube	2009 - 2011	K9K 667	K9K 762	F9Q 731	G9T 720
	Juke	2010 - on	K9K 790	K9K 764	F9Q 732	G9T 742
	Kubistar	2003 - 2009	K9K 792	K9K 766	F9Q 733	G9T 743
	Micra	2003 - 2019	K9K 794	K9K 768	F9Q 734	G9T 744
	Note	2006 - 2013	K9K 796	K9K 770	F9Q 736	2,2 DTI
	NV200/ Evalia	2009 - 2019	K9K 846	K9K 772	F9Q 740	G9T 720
	Primera	2003 - 2007	K9K 856	K9K 774	F9Q 744	G9T 722
	Qashqai	2007 - on	K9K 858	K9K 780	F9Q 748	G9T 750
	Tiida	2007- 2011	K9K 884	K9K 782	F9Q 750	2,5 dCi
	Interstar	2002 - 2011	K9K 892	K9K 800	F9Q 751	G9U 630
	Primastar	2002 - 2012	K9K 894	K9K 802	F9Q 752	G9U 632
			K9K 896	K9K 804	F9Q 754	G9U 650
			K9K 898	K9K 806	F9Q 755	G9U 720
			K9K 276	K9K 808	F9Q 758	G9U 724
Renault	Captur	2013 - 2019	K9K 400	K9K 812	F9Q 759	G9U 726
	Clio II,III,IV	1999 - 2019	K9K 608	K9K 816	F9Q 770	G9U 730
	Espace/Grand Espace III,IV	1999 - 2009	K9K 628	K9K 820	F9Q 780	G9U 750
	Fluence	2009 - 2015	K9K 636	K9K 826	F9Q 782	G9U 754
	Kadjar	2015 - 2018	K9K 646	K9K 830	F9Q 790	2,5 DTI/
	Kangoo	1999 - on	K9K 702	K9K 832	F9Q 800	CDTi
	Laguna I,II,III	1999 - 2015	K9K 704	K9K 834	F9Q 803	G9U 630
	Logan/ Logan MCV	2006 - 2011	K9K 710	K9K 836	F9Q 804	G9U 632
	Megane I,II,III,IV	1997 - 2018	K9K 714	K9K 837	F9Q 808	G9U 650
	Modus/Grand Modus	2004 - 2013	K9K 716	K9K 838	F9Q 812	G9U 720
	Scenic/Grand Scenic I,II,III,IV	1999 - 2018	K9K 718	K9K 842	F9Q 814	G9U 724
	Twingo II	2007 - 2014	K9K 872	1,5 DDiS	F9Q 816	G9U 726
	Vel Satis	2000 - 2009	K9K 500	K9K 262	F9Q 818	G9U 730
	Trafic II	2001 - 2012	K9K 609	K9K 266	F9Q 820	G9U 750
	Master II	2000 - 2011	K9K 629	K9K 299	F9Q 826	G9U 754
			K9K 638	1,9 dCi	F9Q 870	
			K9K 639	F9Q 760	F9Q 872	
			K9K 647	F9Q 762	1,9 DDiS	
Suzuki	Grand Vitara	2005 - 2015	K9K 657	F9Q 772	F9Q B2	
	Jimny	2003 - 2011	K9K 676	F9Q 774	2,2 dCi	
			K9K 677	F9Q 650	G9T 722	
Vauxhall/ Opel	Movano-A	2000 - 2010	K9K 700	F9Q 660	G9T 750	
	Vivaro-A	2002 - 2012	K9K 706	F9Q 664	G9T 600	
			K9K 712	F9Q 670	G9T 605	
			K9K 722	F9Q 674	G9T 606	
			K9K 724	F9Q 680	G9T 607	
			K9K 728	F9Q 690	G9T 642	
			K9K 729	F9Q 710	G9T 645	

Always refer to the website for most up to date applications: www.lasertools.co.uk/product/4076

Applications

The application list for this product has been compiled cross referencing the OEM Tool Code with the Component Code.

In most cases the tools are specific to this type of engine and are necessary for Cam belt or chain maintenance.

If the engine has been identified as an interference engine valve to piston damage will occur if the engine is run with a broken Cam belt.

A compression check of all cylinders should be performed before removing the cylinder head.

Always consult a suitable work shop manual before attempting to change the Cam belt or Chain.

Autodata

Our applications data is supplied by Autodata and we are able to supply this data to you in a PDF format.

If this is a specific kit for a group of engine codes the application list has been supplied showing the main vehicles this kit is designed for and does not list every model each pin fits.

If this is a master kit then all vehicles are included.

The data is the copyright of Tool Connection and should not be reproduced.

If the application data is extensive we have included a CD with the application list in .pdf format.

Languages

We have also included where possible translations for the instructions in the following languages:

- French
- Spanish
- German
- Portuguese
- Italian
- Dutch

The use of these engine timing tools is purely down to the user's discretion and Tool Connection cannot be held responsible for any damage caused what so ever.

ALWAYS USE A REPUTABLE WORKSHOP MANUAL

Instructions

The following instructions are for guidance only. Please refer to OEM derived data such as the vehicle manufacturers' own data or Autodata.

The use of this engine timing tool kit is purely down to the user's discretion and The Tool Connection Ltd. cannot be held responsible for any damage caused whatsoever.



Instructions

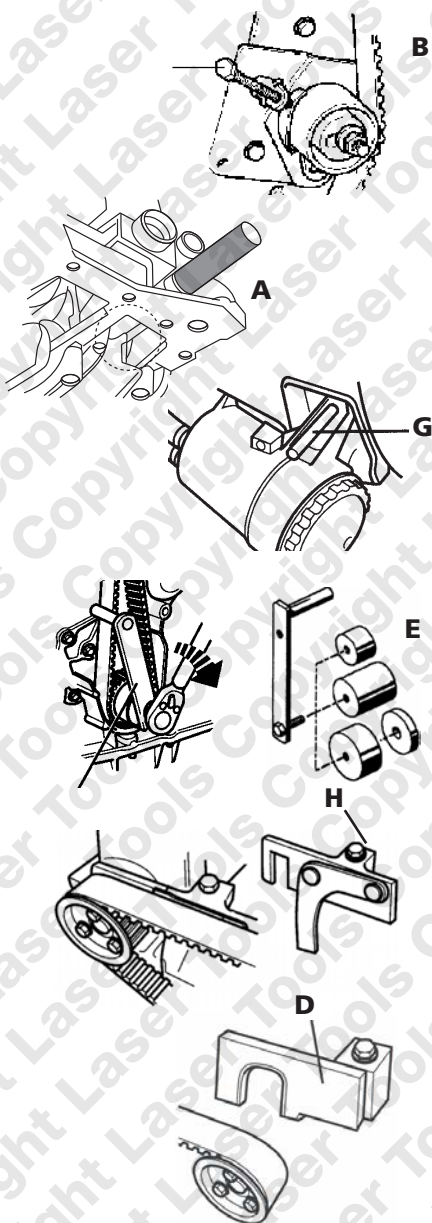

Tensioning Adjustment Screw

To enable the correct tension to be applied to the timing belt.

Crankshaft Timing Pins

There are two different pieces included in this set. As with the camshaft timing pin, they are inserted through the engine block and used to position the crankshaft to achieve the correct timing position of the first cylinder.

It is important that these pieces are used to set the timing position, but are not to be used to lock the flywheel.

Tensioning Tools

To enable the correct pre-tension to be applied to the timing belt, this tool has 4 interchangeable covers and a spacing washer to suit the variety of tensioners used.

Install the exhaust camshaft locking tool and hold in place using the setscrew

If the tool cannot be fitted correctly, rotate the crankshaft one turn clockwise.

Slacken the sprocket fasteners, but check that during installation the fasteners are not positioned at the end of the slots.

The lever arm will make contact with the tensioner. As a visual register the top of the arm will align with the camshaft locking tool when the tensioner is turned anti-clockwise whilst being tensioned using a 6 mm. hex. key.

Install the inlet camshaft locking tool over the vertical flats on the camshaft.

Safety Warnings - please read

- If the engine has been identified as an Interference engine, damage to the engine will occur if the timing belt has been damaged. A compression check of all the cylinders should be taken before the cylinder head (s) are removed.
- Do not turn crankshaft or camshaft when the timing belt/chain has been removed.
- To make turning the engine easier, remove the spark plugs/glow plugs or injectors.
- Observe all tightening torques.
- Do not turn the engine using the camshaft or any other sprocket.
- Disconnect the battery earth lead (check Radio code is available).
- Do not use cleaning fluids on belts, sprockets or rollers.
- Some toothed timing belts are not interchangeable. Check the replacement belt has the correct tooth profile.
- Always mark the belt with the direction of running before removal.
- Do not lever or force the belt onto its sprockets.
- Do not use timing pins to lock the engine when slackening or tightening the crankshaft pulley bolts.
- ALWAYS REFER TO A REPUTABLE MANUFACTURERS WORKSHOP MANUAL.

Our products are designed to be used correctly and with care for the purpose for which they are intended. No liability is accepted by the Tool Connection for incorrect use of any of our products, and the Tool Connection cannot be held responsible for any damage to personnel, property or equipment when using the tools. Incorrect use will also invalidate the warranty.

If applicable, the applications database and any instructional information provided has been designed to offer general guidance for a particular tool's use and while all attention is given to the accuracy of the data no project should be attempted without referring first to the manufacturer's technical documentation (workshop or instruction manual) or the use of a recognised authority such as Autodata.

It is our policy to continually improve our products and thus we reserve the right to alter specifications and components without prior notice. It is the responsibility of the user to ensure the suitability of the tools and information prior to their use.



When you have finished with this tool please recycle it

www.lasertools.co.uk



Distributed by The Tool Connection Ltd

Kineton Road, Southam, Warwickshire CV47 0DR
T +44 (0) 1926 815000 F +44 (0) 1926 815888
info@toolconnection.co.uk www.toolconnection.co.uk

Guarantee

If this product fails through faulty materials or workmanship, contact our service department direct on: **+44 (0) 1926 818186**. Normal wear and tear are excluded as are consumable items and abuse.

4076_Instructions_V2

www.lasertools.co.uk