

## Precautions:

- Always lubricate the threaded force screw (A) and nut/bearing (D) with molybdenum disulphide grease before using the tool. Keep force screw threads clean and free of dirt and debris.
- Do not use air and/or impact tools with this equipment. This will void the warranty.
- Always refer to manufacturer's documentation before commencing the job.
- Do not work on or under a vehicle supported only by a jack. If lifting the vehicle with a jack it must be securely supported on safety axle stands.

Our products are designed to be used correctly and with care for the purpose for which they are intended. No liability is accepted by the Tool Connection for incorrect use of any of our products, and the Tool Connection cannot be held responsible for any damage to personnel, property or equipment when using the tools. Incorrect use will also invalidate the warranty.

If applicable, the applications database and any instructional information provided has been designed to offer general guidance for a particular tool's use and while all attention is given to the accuracy of the data no project should be attempted without referring first to the manufacturer's technical documentation (workshop or instruction manual) or the use of a recognised authority such as Autodata.

It is our policy to continually improve our products and thus we reserve the right to alter specifications and components without prior notice. It is the responsibility of the user to ensure the suitability of the tools and information prior to their use.



**Safety First. Be Protected.**

## Guarantee

This item contains consumable elements that are **NOT** covered by the Tool Connection Guarantee. For spares contact our service department direct on: +44 (0) 1926 818186.



Distributed by The Tool Connection Ltd

Kineton Road, Southam, Warwickshire CV47 0DR  
 T +44 (0) 1926 815000 F +44 (0) 1926 815888  
 info@toolconnection.co.uk www.toolconnection.co.uk



5 018341 060398 >

# LASER<sup>®</sup>

## Bush Tool

Mitsubishi EVO 4/5/6

## Instructions



## Front Track Control Arm Front Bush Tool - Mitsubishi EVO 4/5/6

This tool has been developed to remove and refit the front track control arm front bush with the minimum of dismantling required.

Being able to perform this task on the vehicle saves considerable time over the more traditional use of a workshop press that requires the arm to be completely removed.

### Components

The information given below is for reference only. The Tool Connection recommends the use of Manufacturer data or Autodata where relevant

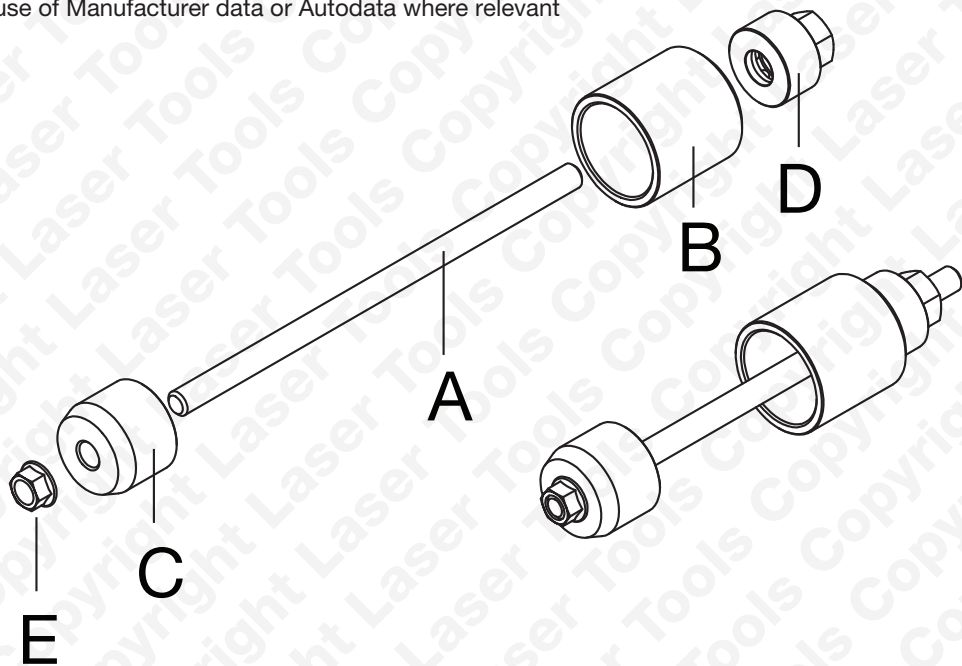

Items A and D are considered consumable items.

Note: Max safe working torque for item 1 is 80Nm.

**Always ensure the force screw and nut assembly are well lubricated with molybdenum disulphide grease.**

Number	Description
A	Force screw M12 - (Consumable Part No. 1319)
B	Receiver Cup - Large shell
C	Push Cup - Small cup
D	M12 nut/bearing assembly - (Consumable Part No. 2138)
E	M12 x 1.75mm nut

### Preparation

- It is advised that any mounting bolts should be sprayed with penetrating oil prior to dismantling.
- Mount the vehicle on a lift, wheels free.
- Remove relevant wheel.
- Remove the relevant anti roll bar link
- Remove front bush centre bolt and rear bush retaining bolt
- Lower the wishbone away to gain access to the bush and clean up the working area.

### Instructions - Extraction

Assemble the tool as shown in Fig. 1 so that the old bush pulls out of the arm into (B). Ensure (C) remains straight and pulls into the arm with out damaging the edge of the arm.

Fig. 1

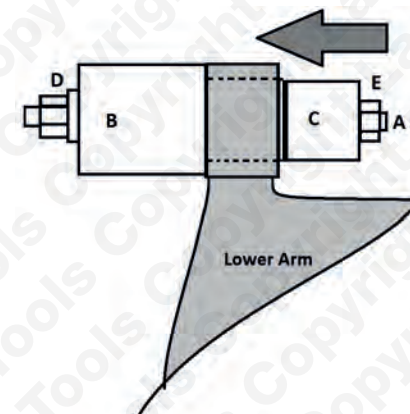

**Important:** Ensure all components remain straight and aligned or damage will result. 80 Nm Maximum torque.

### Instructions - Insertion

For insertion set the tool as shown in Fig. 2.

Continue pushing the bush into the arm until the bush protrudes evenly from both sides of the arm.

Fig. 2

