

Part No. 8012

# LASER®

## **Cordless Impact Screwdriver 20V** w/o Battery

### **Instructions**



[www.lasertools.co.uk](http://www.lasertools.co.uk)



## Introduction

This cordless impact screwdriver is part of the Laser professional workshop 'one battery powers all' cordless tool range with brushless motor technology designed and built for daily use. Cordless power is fast becoming the experts' choice over mains and pneumatic, bringing extra safety to the workforce environment.

This impact screwdriver is a compact design with comfortable grip; supplied with soft-grip body for added control. It features a quick-release bit holder, and sturdy belt clip attached to tool. There are three torque settings, plus a fourth setting that automatically adjusts the speed to suit the torque required.

This cordless tool is powered by a 4Ah lithium-ion battery (not included) that delivers fade-free performance for the entire run time. The tool will not experience a slow, gradual loss of power. When the battery needs to be charged the tool will stop. No memory effect on the battery allows the battery to quickly recover from a deep discharge with no reduction of capacity. The battery features an LED power-bar to determine its condition (level of power available).

**Note:** battery and battery charger not included. These are available under the following part numbers:

- |       |  |
|-------|--|
| 8007: | 10-cell lithium-ion battery - 4.0Ah.                   |
| 8008: | Mains powered battery charger — fitted with UK plug.   |
| 8009: | Mains powered battery charger — fitted with euro plug. |

Refer to specific instructions included with battery and battery charger for details of fitting the battery pack to the tool and charging method.

## Components

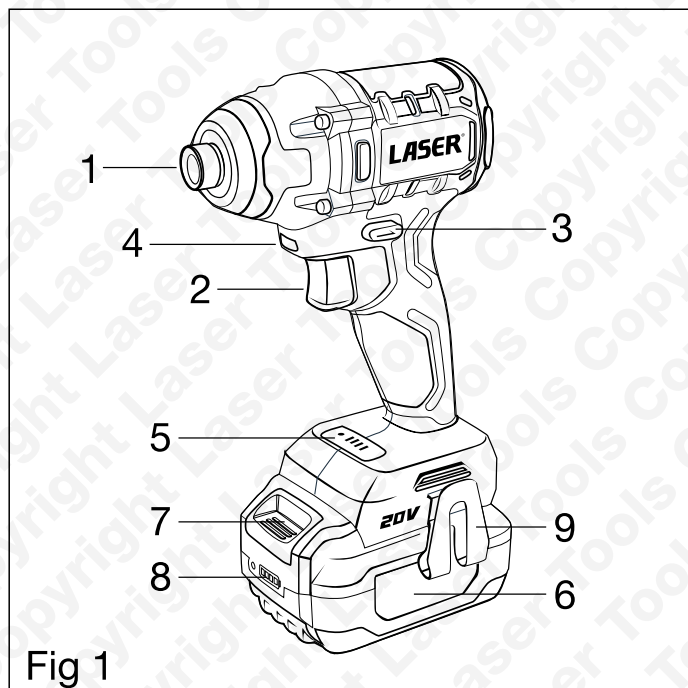

Fig 1

Ref.	Description
1	Quick-release bit holder
2	Trigger
3	Forward / Reverse selector
4	LED worklight
5	Torque selector
6	Battery (not included)
7	Battery release button
8	Battery condition LED indicators
9	Belt Hook

## Instructions

### Specifications

Voltage	20V
No load speed	0-2800 RPM
Impact per minute	0-3100 BPM
Maximum torque	200 Nm
Chuck	Quick-release
Noise	90.8 dB (approx.)
Weight (no battery)	1.7kg
Weight (with battery)	2.3kg

### Operation:



## Instructions

**WARNING:** Remove battery pack before any cleaning or maintenance is carried out.

- Refer to specific instructions included with battery and battery charger for details of fitting the battery pack to the tool and charging method.
- Refer to Figure 1: Ensure the Forward / Reverse selector (3) is in the centre LOCK position, before inserting the required screwdriver bit into the quick-release bit holder.
- Pull the collet on the quick-release bit holder forward (away from the tool) and insert the bit holder and bit. Then pull the inserted bit holder forward to lock in place.
- Only use quick-chuck type bits or bit holder. Do not use standard bits without the suitable quick-chuck holder.
- Note: In impact mode, use with suitable impact-grade bits only.
- Set the Forward / Reverse selector (3) to the desired function.
- Set the desired torque setting by pressing the torque selector button (5). There are four torque settings:
  1. Low.
  2. Medium.
  3. High.
  4. Intelligent adjustment control (tool adjusts speed to suit the torque required).
- Squeeze the trigger to start the screwdriver; further pressure will increase the speed subject to the selected torque setting.
- The LED worklight (4) lights up and shines onto the job when the trigger is depressed. It stays on for approximately 4-6 seconds after the trigger is released.
- When finished, remove the bit holder by pulling the collet on the quick-release bit holder forward (away from the tool) to release.
- The tool features overload and overheating protection. Power to the motor will be cut off to extend tool and battery life if the tool is overloaded (draws an abnormally high current) or overheats. Stop the condition that has caused the overload, or let the tool cool down before restarting. If overheating, clean the tool using a dry cloth and soft brush. Then use clean, dry compressed air to blow through the air vents.

## Safety Warnings - please read



- Ensure that all operators have read and understood these instructions.
- Wear approved PPE: eye protection, ear defenders, gloves and protective clothing. If the screwdriving task generates dust, wear a particle mask.
- Ensure no loose clothing, ties, watches, jewellery, etc. Contain long hair.
- Keep work area clean, tidy and free for any obstructions. Ensure adequate lighting.
- Refer to specific instructions included with battery and battery charger for details of fitting the battery pack to the tool and charging method.
- Always remove the battery pack before performing any maintenance.
- Only use quick-chuck type bits or bit holder. Do not use standard bits without the suitable quick-chuck holder.
- Note: In impact mode, use with suitable impact-grade bits only.
- Ensure workpiece cannot move around — mount in a vice or secure with clamps if necessary.
- Do not carry the screwdriver with your finger on the trigger.
- Do not use the screwdriver if it is damaged or parts are missing.
- Do not operate the screwdriver in the presence of flammable material, liquids or gases.
- Do not let the air vents on the screwdriver become clogged with dirt or covered in any way; this will cause overheating.
- Do not let the screwdriver get wet or use in damp or wet conditions.
- Do not use the screwdriver as a fixed tool (for example, mounted in a vice).
- When not in use, remove the battery pack and store in dry, secure conditions.
- Keep the Forward / Reverse selector (3) in the centre LOCK position until the screwdriver is required for use.
- Keep the tool clean at all times. Always wear eye protection and protective gloves when cleaning the tool. For cleaning use a dry cloth and soft brush. Water must never come in contact with the tool. Use clean, dry compressed air to blow through the air vents.
- Do not use the screwdriver for tasks it is not designed for. Use the product correctly and with care. Failure to do so may cause damage and/or personal injury and will invalidate the warranty.

**WARNING:** Risk of hand and arm vibration injury. The operator (or employer) will need to carry out a health and safety risk assessment to determine a suitable duration for the use of the tool. This will be affected by the operator, the task, the material of the workpiece, and condition of tool.

Our products are designed to be used correctly and with care for the purpose for which they are intended. No liability is accepted by the Tool Connection for incorrect use of any of our products, and the Tool Connection cannot be held responsible for any damage to personnel, property or equipment when using the tools. Incorrect use will also invalidate the warranty.

If applicable, the applications database and any instructional information provided has been designed to offer general guidance for a particular tool's use and while all attention is given to the accuracy of the data no project should be attempted without referring first to the manufacturer's technical documentation (workshop or instruction manual) or the use of a recognised authority such as Autodata.

It is our policy to continually improve our products and thus we reserve the right to alter specifications and components without prior notice. It is the responsibility of the user to ensure the suitability of the tools and information prior to their use.



## Safety First. Be Protected.

### Guarantee

In addition to the standard 12 months warranty offered on all Tool Connection products, by registering your cordless power tool, you will receive an additional 2 years warranty.



To register your product please visit:

[www.toolconnection.co.uk/powertools/productregistration](http://www.toolconnection.co.uk/powertools/productregistration)

Please register within 30 days of purchase. Non-registered products remain under our standard 12-month product warranty. See our full terms and conditions for further details.



[www.lasertools.co.uk](http://www.lasertools.co.uk)



Distributed by The Tool Connection Ltd  
Kineton Road, Southam, Warwickshire CV47 0DR  
T +44 (0) 1926 815000 F +44 (0) 1926 815888  
info@toolconnection.co.uk [www.toolconnection.co.uk](http://www.toolconnection.co.uk)

### Guarantee

If this product fails through faulty materials or workmanship, contact our service department direct on: **+44 (0) 1926 818186**. Normal wear and tear are excluded as are consumable items and abuse.

8012\_Instructions\_V2

[www.lasertools.co.uk](http://www.lasertools.co.uk)



Part No. 8009

# LASER<sup>®</sup>

## **Battery Charger 230V Mains 4amp** with Euro 2 Pin Plug

### **Instructions**



[www.lasertools.co.uk](http://www.lasertools.co.uk)

## Introduction

This is a professional workshop 'one battery powers all' cordless tool range with brushless motor technology designed and built for daily use. This 230V (4 Amp) battery charger is used with the 10-cell lithium batteries (part number 8007). Features include diagnostic LED plus built-in protection against overheating and overcharging. CE and Rohs approved. Average charge time: 1 hour. Battery discharge time approximately 40min – 115min depending on tool and usage.

Cordless power is fast becoming the experts' choice over mains and pneumatic, bringing extra safety to the workforce environment.

## Components

Fig 1

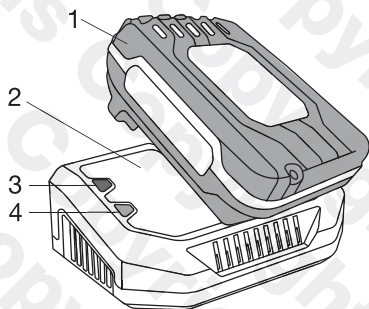

Ref.	Description
1	*Battery (Li-ion 20V 4Ah)
2	Charger
3	LED: ON (red)
4	LED: CHARGING (green)

\*Battery shown for illustration purposes only and is not included with the charger.

## Instructions

### Charging:

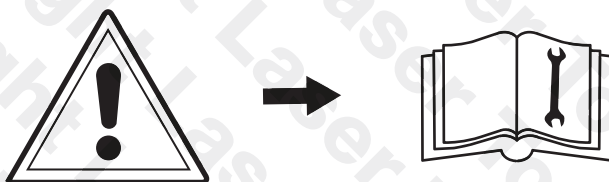

Although the batteries are supplied partially charged, always fully charge the battery before first use.

1. Only use this charger with the correct Laser cordless tool range battery (Li-ion 20V 4Ah — part number 8007).
2. Connect the charger to the mains power supply.
3. Align the raised ribs on the battery with the slot on the charger; slide the battery onto the charger and push fully home until the release button clicks into place.
4. Refer to Figure 1: the LEDs (3 and 4) will light and evaluate the condition of the battery:
5. Red LED ON and green LED FLASHING: battery is charging.
6. Red LED ON and green LED ON: battery is fully charged.
7. Red LED and green LED flash alternately: charger is faulty.

## Instructions

Fig 2

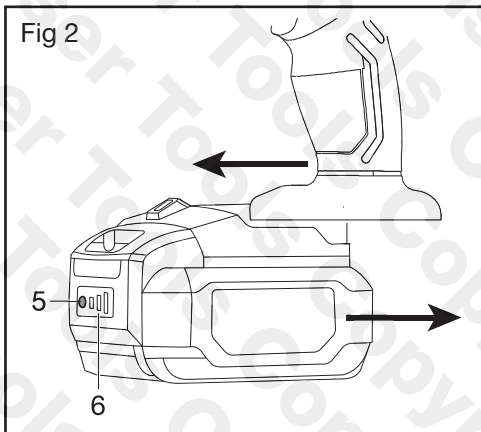

Ref.	Description
5	Battery condition button
6	Battery condition LEDs

The lithium-ion battery pack delivers fade-free performance for the entire run time. The tool will not experience a slow, gradual loss of power. When the battery needs to be charged the tool will stop. No memory effect on the battery allows the battery to quickly recover from a deep discharge with no reduction of capacity.

Refer to Figure 2: To determine the condition of the battery pack (level of power available) press the battery condition button (5). The power-bar of blue battery condition LEDs (6) will light up — three LEDs mean full power, and as the power level is depleted the power-bar will display less LEDs. When the battery's power has run out, and the trigger on the tool is pressed, the LEDs on the power-bar will flash rapidly. The battery pack should now be recharged. Average charge time: 1 hr.

Remove the battery by depressing the release button then slide off the tool. See section above (Charging) and recharge the battery.

## Safety Warnings - please read

Although the batteries are supplied partially charged, always fully charge the battery before first use.

1. Only use this charger with the correct Laser cordless tool range battery (Li-ion 20V 4Ah — part number 8007).
2. Connect the charger to the mains power supply.
3. Align the raised ribs on the battery with the slot on the charger; slide the battery onto the charger and push fully home until the release button clicks into place.
4. Refer to Figure 1: the LEDs a vv(3 and 4) will light and evaluate the condition of the battery:
5. Red LED ON and green LED FLASHING: battery is charging.
6. Red LED ON and green LED ON: battery is fully charged.
7. Red LED and green LED flash alternately: charger is faulty.

Our products are designed to be used correctly and with care for the purpose for which they are intended. No liability is accepted by the Tool Connection for incorrect use of any of our products, and the Tool Connection cannot be held responsible for any damage to personnel, property or equipment when using the tools. Incorrect use will also invalidate the warranty.

If applicable, the applications database and any instructional information provided has been designed to offer general guidance for a particular tool's use and while all attention is given to the accuracy of the data no project should be attempted without referring first to the manufacturer's technical documentation (workshop or instruction manual) or the use of a recognised authority such as Autodata.

It is our policy to continually improve our products and thus we reserve the right to alter specifications and components without prior notice. It is the responsibility of the user to ensure the suitability of the tools and information prior to their use.



**Safety First. Be Protected.**



5 018341 080099 >



When you have finished with  
this bottle please recycle it

[www.lasertools.co.uk](http://www.lasertools.co.uk)



Distributed by The Tool Connection Ltd

Kington Road, Southam, Warwickshire CV47 0DR

T +44 (0) 1926 815000 F +44 (0) 1926 815888

[info@toolconnection.co.uk](mailto:info@toolconnection.co.uk) [www.toolconnection.co.uk](http://www.toolconnection.co.uk)

#### Guarantee

If this product fails through faulty materials or workmanship, contact our service department direct on: **+44 (0) 1926 818186**. Normal wear and tear are excluded as are consumable items and abuse.

8009\_Instructions\_V2

**[www.lasertools.co.uk](http://www.lasertools.co.uk)**