

LASER[®]

Part No. 6292

Instructions

Engine Timing Tool Kit Alfa Romeo, Lancia

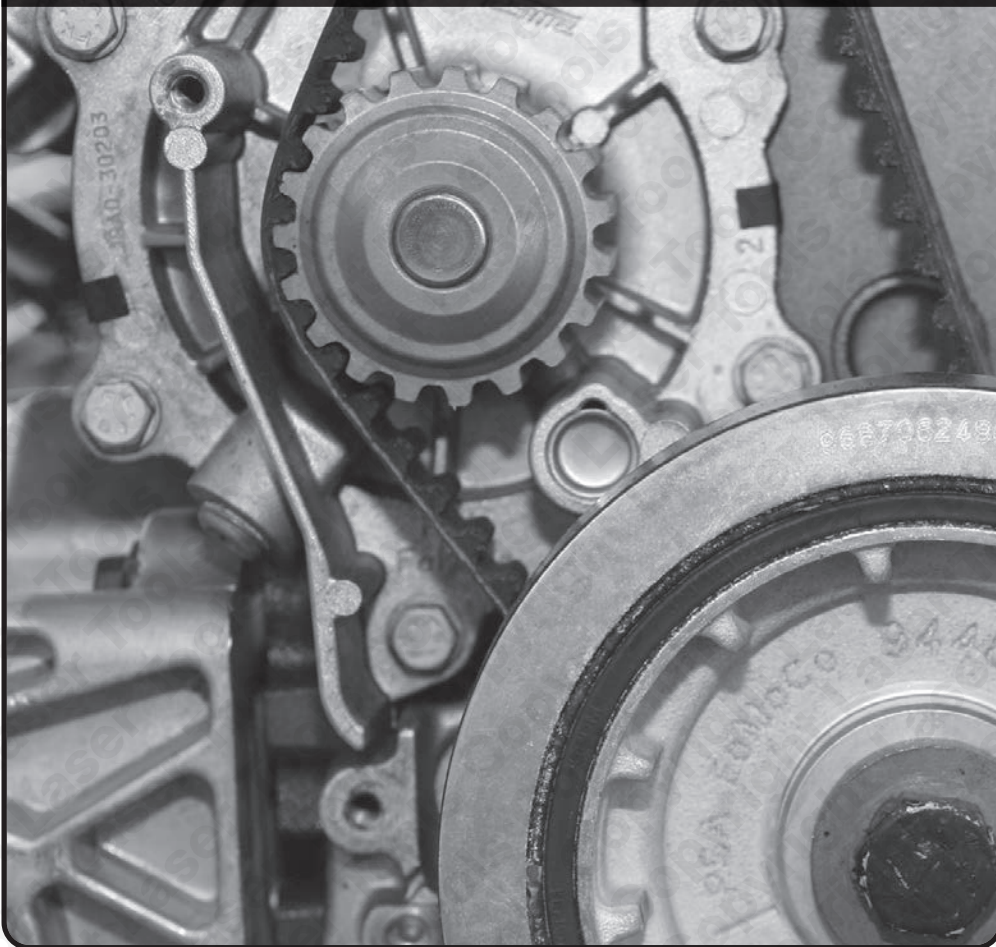

*Please refer to www.lasertools.co.uk/toolpoint
to check the most up to date product applications.*

www.lasertools.co.uk

Introduction

Designed for the post 2009 Alfa Romeo 1,75lt 4 cylinder twin camshaft turbo charged engines.

- N.B The information given below is for reference only.
- The Tool Connection recommends the use of Manufacturer data or Autodata.
- The Tool Connection cannot be held responsible for damage to engine or personnel whilst using this tool kit.

Components

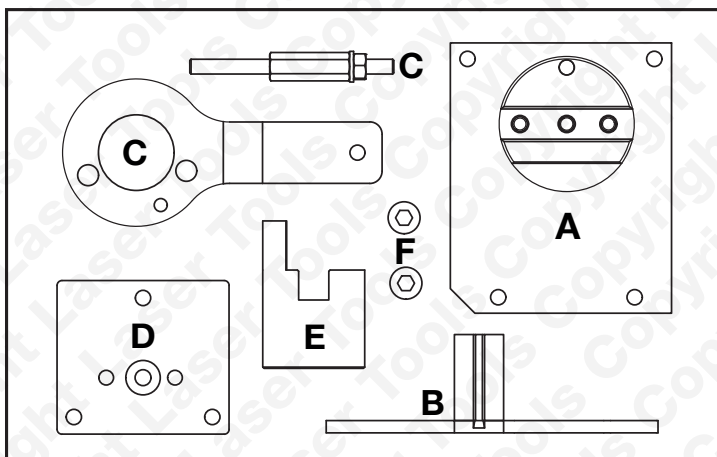

Ref.	Code	OEM Ref.	Description
A, D, E, F	C709	2 000 033 500	Camshaft Locking Tool (Ex) Camshaft Locking Tool (In) Back Plate/Alignment Boss
B	C148	1 860 898 000	Flywheel Locking Tool
C	C277	2 000 003 000	Crankshaft Locking Tool and Stud

Applications

- Always consult a suitable work shop manual before attempting to change the Cam belt or Chain.
- The use of these engine timing tools is purely down to the user's discretion and The Tool Connection cannot be held responsible for any damage caused what so ever.

ALWAYS USE A REPUTABLE WORKSHOP MANUAL

Marque	Model	Year	Description
Alfa Romeo	159	2009 - 2012	1,75 Tbi
	Brera	2009 - 2011	939B1.000
	Giulietta	2010 - 2019	940A1.000
	Spider	2009 - 2011	940B2.000
	4C	2013 - 2019	960A1.000
Lancia	Delta	2009 - 2014	1,75 DI Turbo Jet
			939B1.000

Always refer to the website for most up to date applications: www.lasertools.co.uk/product/6292

Instructions

The following instructions are for guidance only. Please refer to OEM derived data such as the vehicle manufacturers' own data or Autodata.

The use of this engine timing tool kit is purely down to the user's discretion and The Tool Connection Ltd. cannot be held responsible for any damage caused whatsoever.



- Always refer to manufacturer specific data and instructions

Component Descriptions:

Component A:

Used to lock the exhaust camshaft in its timed position.
Component A fits in to the back of the camshaft (gearbox end). In order to gain access to the camshaft the vacuum pump must be removed. Turn the crankshaft to the required setting position and fit component A as shown in Fig. 1.

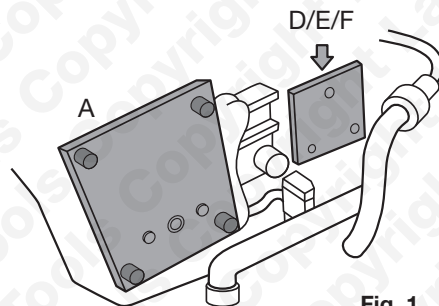

Fig. 1

Component D/E/F:

Used to lock the Inlet camshaft in its timed position.
Assemble components D, E and one of F as shown in Fig. 2.

Use the assembly to lock the inlet cam as shown in Fig. 1.

N.B. On engines equipped with VCT, if the VCT pulleys require removal or loosening ensure their initial position is marked with chalk or paint.

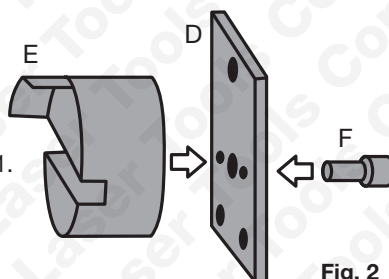

Fig. 2

Instructions

Component C:

Used to lock the crankshaft in its timed position.
With the front crankshaft pulley removed fit C as shown in Fig. 3.

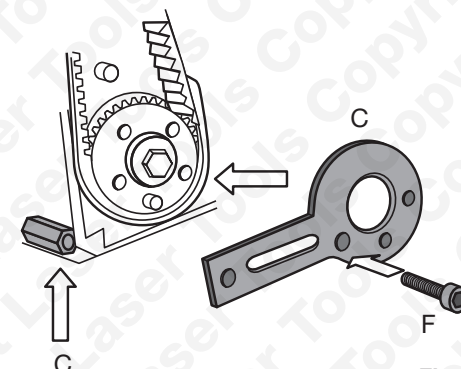

Fig. 3

Component B:

Used to lock the flywheel on the Alfa Giulietta.
B fits into the flywheel ring gear at the bottom of the gearbox bell housing as shown in Fig. 4.

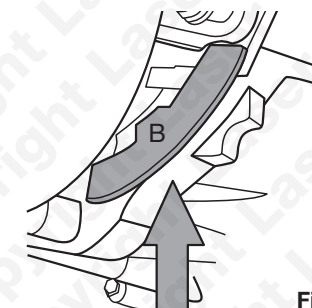

Fig. 4

Safety Warnings - please read

Incorrect or out of phase engine timing can result in damage to the valves.
The Tool Connection cannot be held responsible for any damage caused by using these tools in anyway.

- If the engine has been identified as an Interference engine, damage to the engine will occur if the timing belt has been damaged. A compression check of all the cylinders should be taken before the cylinder head (s) are removed.
- Do not turn crankshaft or camshaft when the timing belt/chain has been removed.
- To make turning the engine easier, remove the spark plugs/glow plugs or injectors.
- Observe all tightening torques.
- Do not turn the engine using the camshaft or any other sprocket.
- Disconnect the battery earth lead (check Radio code is available).
- Do not use cleaning fluids on belts, sprockets or rollers.
- Some toothed timing belts are not interchangeable. Check the replacement belt has the correct tooth profile.
- Always mark the belt with the direction of running before removal.
- Do not lever or force the belt onto its sprockets.
- Do not use timing pins to lock the engine when slackening or tightening the crankshaft pulley bolts.
- ALWAYS REFER TO A REPUTABLE MANUFACTURERS WORKSHOP MANUAL.

Our products are designed to be used correctly and with care for the purpose for which they are intended. No liability is accepted by the Tool Connection for incorrect use of any of our products, and the Tool Connection cannot be held responsible for any damage to personnel, property or equipment when using the tools. Incorrect use will also invalidate the warranty.

If applicable, the applications database and any instructional information provided has been designed to offer general guidance for a particular tool's use and while all attention is given to the accuracy of the data no project should be attempted without referring first to the manufacturer's technical documentation (workshop or instruction manual) or the use of a recognised authority such as Autodata.

It is our policy to continually improve our products and thus we reserve the right to alter specifications and components without prior notice. It is the responsibility of the user to ensure the suitability of the tools and information prior to their use.



6292_Instructions_v3



www.lasertools.co.uk



Distributed by The Tool Connection Ltd
Kineton Road, Southam, Warwickshire CV47 0DR
T +44 (0) 1926 815000 F +44 (0) 1926 815888
info@toolconnection.co.uk www.toolconnection.co.uk

Guarantee

If this product fails through faulty materials or workmanship, contact our service department direct on: **+44 (0) 1926 818186**. Normal wear and tear are excluded as are consumable items and abuse.

www.lasertools.co.uk