

## Precautions:

Our products are designed to be used correctly and with care for the purpose for which they are intended. No liability is accepted by the Tool Connection for incorrect use of any of our products, and the Tool Connection cannot be held responsible for any damage to personnel, property or equipment when using the tools. Incorrect use will also invalidate the warranty.

If applicable, the applications database and any instructional information provided has been designed to offer general guidance for a particular tool's use and while all attention is given to the accuracy of the data no project should be attempted without referring first to the manufacturer's technical documentation (workshop or instruction manual) or the use of a recognised authority such as Autodata.

It is our policy to continually improve our products and thus we reserve the right to alter specifications and components without prior notice. It is the responsibility of the user to ensure the suitability of the tools and information prior to their use.



**Safety First. Be Protected.**

6505\_Instructions\_v5

### Guarantee

This item contains consumable elements that are **NOT** covered by the Tool Connection Guarantee. For spares contact our service department direct on: +44 (0) 1926 818186.



Distributed by The Tool Connection Ltd

Kineton Road, Southam, Warwickshire CV47 0DR  
T +44 (0) 1926 815000 F +44 (0) 1926 815888  
info@toolconnection.co.uk www.toolconnection.co.uk



6505

# LASER<sup>®</sup>

## Suspension Bush Tool Land Rover

### Instructions

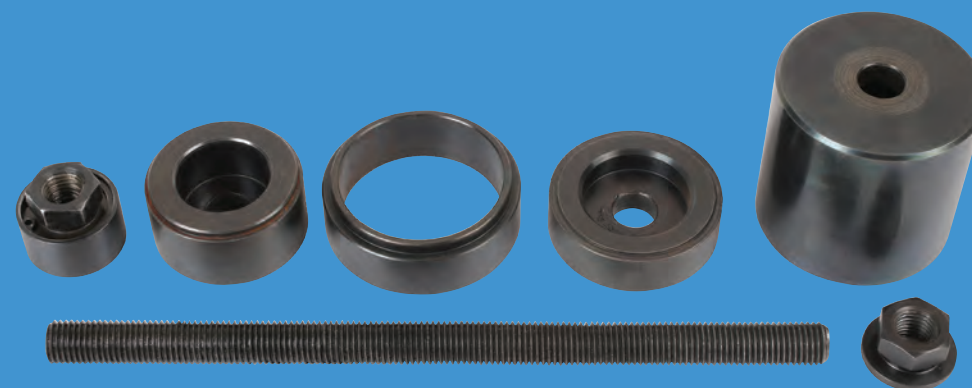

- Application: Land Rover Discovery 1 and 2 Radius Arm Bushes arm to axle bush OEM RBX101680 and radius arm to body bush OEM RBX10173
- Application: Range Rover Classic, Land Rover Discovery 1 and 2.
- Equivalent to OEM tool numbers: OEM 204-502 and 204-496

[www.lasertools.co.uk](http://www.lasertools.co.uk)

[www.lasertools.co.uk](http://www.lasertools.co.uk)

## Suspension Bush Tool - Land Rover

Remove and refit the front and rear bushes of both the front and rear radius arms. Designed to work with OEM bushes RBX 101680 and RBX 101730.

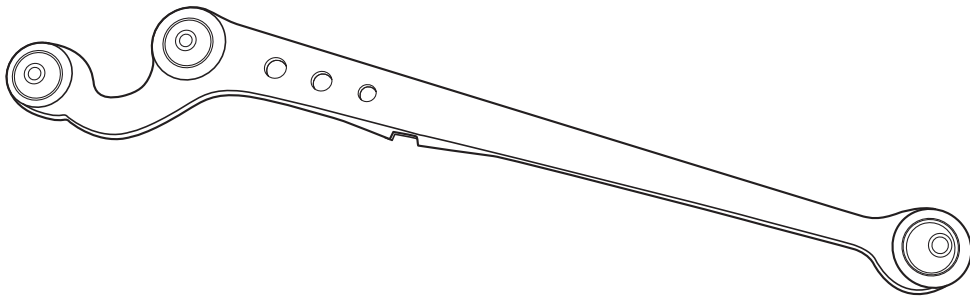

## Components

The information given below is for reference only. The Tool Connection recommends the use of Manufacturer data or Autodata where relevant

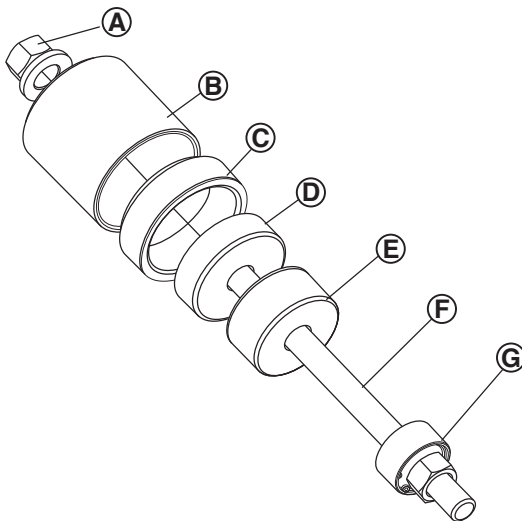

Ref.	Description
A	M16 x 2 nut
B	Axles Bush Receiver
C	Body Bush Receiver Extension
D	Axle Bush Extractor/Inserter
E	Body Bush Extractor/Inserter
F	Threaded Bar - (Consumable Part No. 2317)
G	Force Nut Assembly (Consumable Part No. 1810)

**Always ensure the force screw and nut assembly are well lubricated with molybdenum disulphide grease.**

## Components

**IMPORTANT: ENSURE THE FORCE SCREW IS WELL LUBRICATED WITH MOLYBDENUM DISULPHIDE GREASE (sachet included).**

- It is advised that any mounting bolts should be sprayed with penetrating oil prior to dismantling.
- Mount the vehicle on a ramp with the vehicles axles supported
- Remove only the bolts that hold the radius arm in place.
- It is advised to do one arm at a time.

## Instructions For Use

### Extraction – Body End Bush:

- Note the position and depth of insertion of the existing bush.
- Assemble the bush tool as shown in figure 1 (lubricate the force screw thread and nuts with Molybdenum Disulphide grease) and wind the bush out.
- Ensure the assembled components start and remain properly aligned.

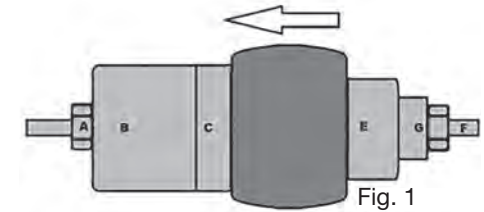

### Insertion – Body End Bush:

- Clean up arm and ensure all loose rust is removed from the area immediately around the bush eyes.
- Line up the new bush and assemble the bush tool as shown in Fig 4 (ensure all dirt or grit that may have contaminated the threaded bar during extraction has been removed and the bar re-greased).
- Wind the bush back into the eye of the arm until properly aligned.

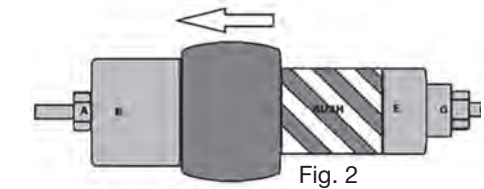

### Extraction – Axle End Bushes (both):

- Use the following instructions for removal of both axle end bushes.
- Note the position and depth of insertion of the existing bush.
- Assemble the bush tool as shown in Fig 3 (lubricate the force screw thread and nuts with Molybdenum Disulphide grease) and wind the bush out.
- Ensure the assembled components start and remain properly aligned.

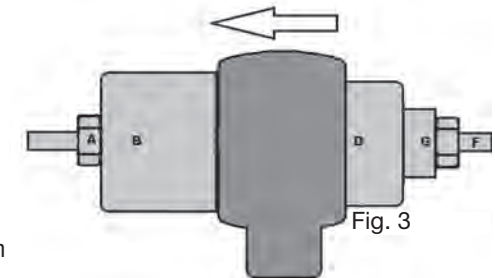

### Insertion – Axle End Bushes (both):

- Clean up arm and ensure all loose rust is removed from the area immediately around the bush eye.
- Line up the new bush and assemble the bush tool as shown in Fig 2 (ensure all dirt or grit that may have contaminated the threaded bar during extraction has been removed and the bar re-greased).
- Wind the bush back into the eye of the arm until properly aligned.

