

LASER[®]

Part No. 6561

Instructions

Timing Tool Kit

Ford 1.25, 1.4, 1.6 16V,
1.2, 1.5, 1.6 TI-VCT

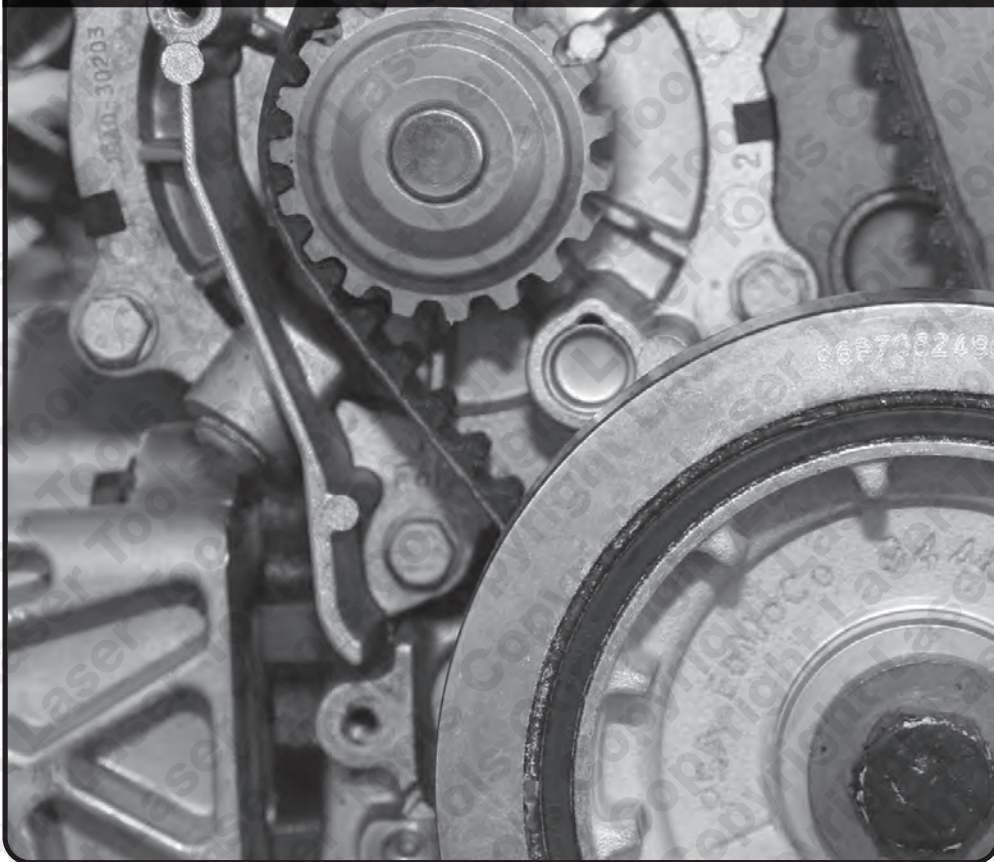

*Please refer to www.lasertools.co.uk/toolpoint
to check the most up to date product applications.*

www.lasertools.co.uk

Introduction

- The essential camshaft and crankshaft alignment tools for the popular 1.2, 1.5, 1.6 Ti-VCT Ford petrol engines (2007 to 2018).
- This kit is also suitable for the earlier 16V engines found in Ford, Mazda & Volvo (1995 to 2008).
- Can be used with the following replacement belt kits: INA 530 0140 10, INA 530 0495 10; Contitech CT881K2, CT881K3, CT881K5; Gates K025433XS, K015669XS, K035669XS.
- Additional tool required: Flywheel Locking Tool - Laser Part No. 4275.

Components

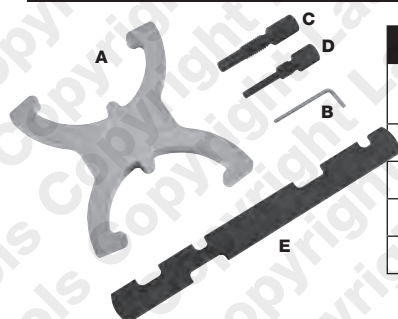

Ref.	Code	OEM Ref	Description
A	C349	303-1097	Cam-shaft sprocket locking tool
B	C282	303-1054	Tensioner pin
C	C311	303-748	Crankshaft timing pin
D	C035	303-507	Crankshaft timing pin
E	C312	303-376B	Cam-shaft locking strap

- Additional tools: Laser 4275.

Timing Belt Numbers

INA	Contitech	Gates
INA 530 0140 10	CT881K2	K025433XS
INA 530 0495 10	CT881K3	K015669XS
	CT881K5	K035669XS

Instructions

The following instructions are for guidance only. Please refer to OEM derived data such as the vehicles manufactures own data or Autodata.

The use of this Tool is purely down to the user's discretion and The Tool Connection Ltd. cannot be held responsible for any damage caused whatsoever.



Instructions (Cont)

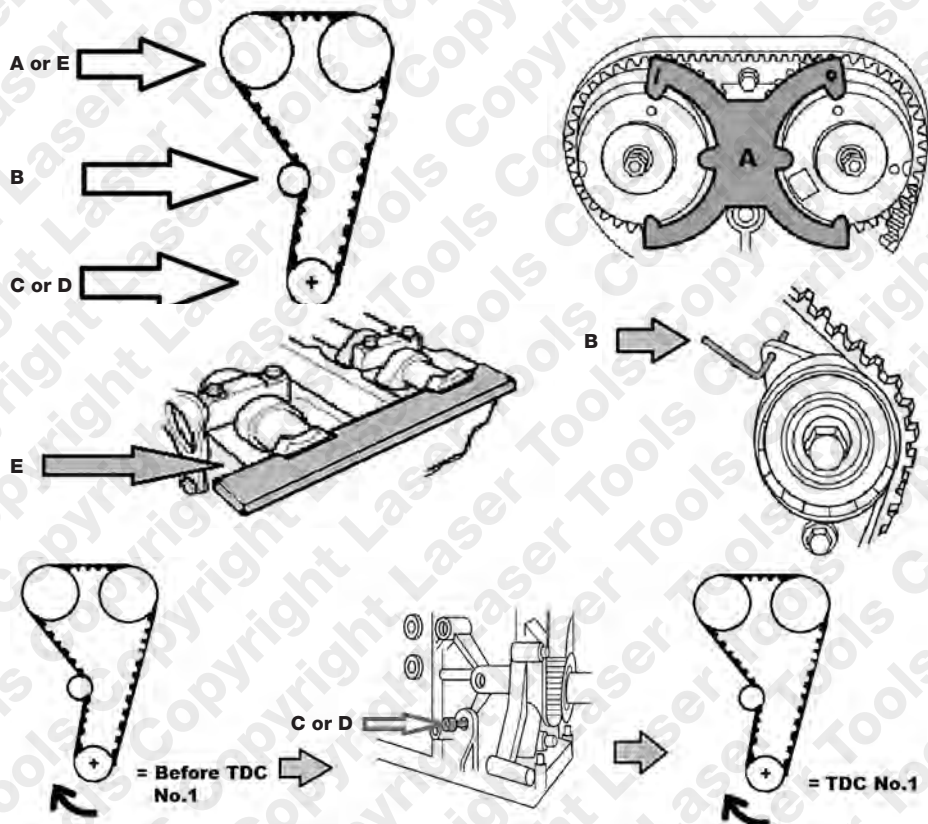

Applications

Make, Model, Range, Year				Engine Codes	
Ford	B-MAX	16V	2012 - 2018	1.25 16V	1.2 Ti-VCT
	C-MAX	Ti-VCT	2007 - 2010	DHA, DHB, DHC, DHD, DHE, DHF, DHG, FUJA, FUJB, M7JA, M7JB, SNJA, SNJB, SNJC, SNJD, STJA, STJB, STJC	B2KA, YSKD, YSKE
	C-MAX/Grand C-MAX		2010 - 2015		1.5 Ti-VCT
	EcoSport		2013 - 2018		ENUE, UEJB, UEJE
	Fiesta IV		1995 - 2002		1.6 Ti-VCT
	Fiesta V		2002 - 2008		HXDA, HXDB, HXJA, HXJB, HXJE, IQDA, IQDB, IQDC, IQJA, IQJC, IQJE, KGBA, MUDA, MUDD, PNBA, PNDA, PNDD, RHBA, RVJA, SIDA, U5JA, XTDA, XTDB
	Fiesta VI, VII		2008 - 2018		
	Focus III		1998 - 2004		
	Focus/ Focus C-MAX		2004 - 2012		
	Focus III		2011 - 2018		
	Fusion		2002 - 2012		
	KA+		2016 - 2018		
	Mondeo IV		2007 - 2015		
	Puma		1997 - 2002		
Mazda	121 Mk III		1996 - 2003	1.6 16V	
	2		2003 - 2007	FYDA, FYDB, FYDC, FYDD, FYDH, FYJA, FYJB, FYJC, HWDA, HWDB, L1T, L1V, L1W, SHDA, SHDB, SHDC	
Volvo	S40 II 1.6		2004 - 2012		
	V50 1.6		2004 - 2012		

Always refer to the website for most up to date applications: www.lasertools.co.uk/product/6561

Safety Warnings - please read

- If the engine has been identified as an Interference engine, damage to the engine will occur if the timing belt has been damaged. A compression check of all the cylinders should be taken before the cylinder head (s) are removed.
- Do not turn crankshaft or camshaft when the timing belt/chain has been removed.
- To make turning the engine easier, remove the spark plugs/glow plugs or injectors.
- Observe all tightening torques.
- Do not turn the engine using the camshaft or any other sprocket.
- Disconnect the battery earth lead (check Radio code is available).
- Do not use cleaning fluids on belts, sprockets or rollers.
- Some toothed timing belts are not interchangeable. Check the replacement belt has the correct tooth profile.
- Always mark the belt with the direction of running before removal.
- Do not lever or force the belt onto its sprockets.
- Do not use timing pins to lock the engine when slackening or tightening the crankshaft pulley bolts.
- ALWAYS REFER TO A REPUTABLE MANUFACTURERS WORKSHOP MANUAL.



Safety First. Be Protected.

Our products are designed to be used correctly and with care for the purpose for which they are intended. No liability is accepted by the Tool Connection for incorrect use of any of our products, and the Tool Connection cannot be held responsible for any damage to personnel, property or equipment when using the tools. Incorrect use will also invalidate the warranty.

If applicable, the applications database and any instructional information provided has been designed to offer general guidance for a particular tool's use and while all attention is given to the accuracy of the data no project should be attempted without referring first to the manufacturer's technical documentation (workshop or instruction manual) or the use of a recognised authority such as Autodata.

It is our policy to continually improve our products and thus we reserve the right to alter specifications and components without prior notice. It is the responsibility of the user to ensure the suitability of the tools and information prior to their use.



6561_Instructions_V5



www.lasertools.co.uk



Distributed by The Tool Connection Ltd
Kineton Road, Southam, Warwickshire CV47 0DR
T +44 (0) 1926 815000 F +44 (0) 1926 815888
info@toolconnection.co.uk www.toolconnection.co.uk

Guarantee

If this product fails through faulty materials or workmanship, contact our service department direct on: **+44 (0) 1926 818186**. Normal wear and tear are excluded as are consumable items and abuse.

www.lasertools.co.uk