

Part No. 6847

LASER[®]

Rear Swinging Arm Bush Tool for Ford

Instructions

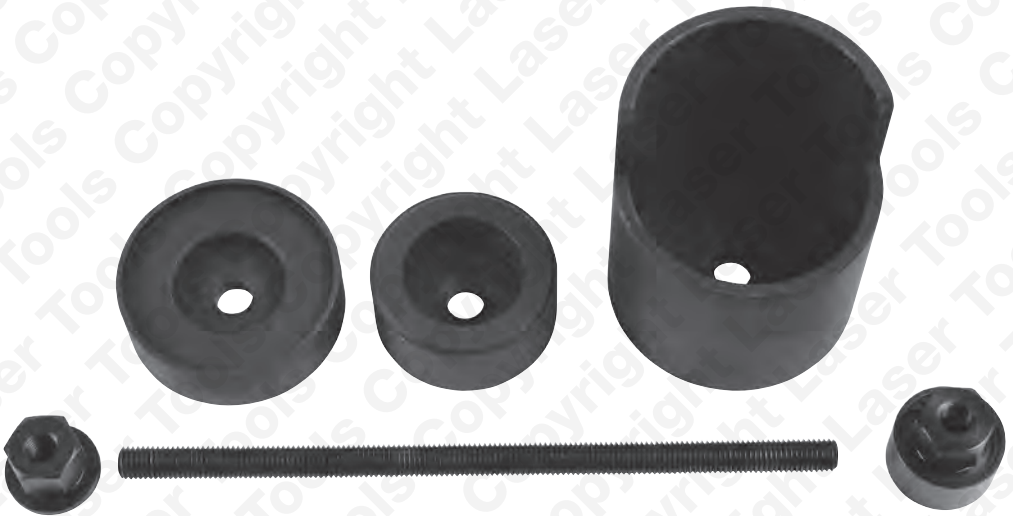

www.lasertools.co.uk

Introduction

- Application: Ford Fiesta Mk VI (2008 - 2017).
- Designed to be used on car with the minimal strip down reducing the time taken to replace worn bushes.
- Suitable for Ford OEM bushes: 1 535 296 & 1 805 815.
- Supplied with molybdenum disulphide grease for extended force screw life.
- Consumable replacement parts: M12 Nut Assembly (Part No. 1803), Force Screw (Part No. 1319).

Components

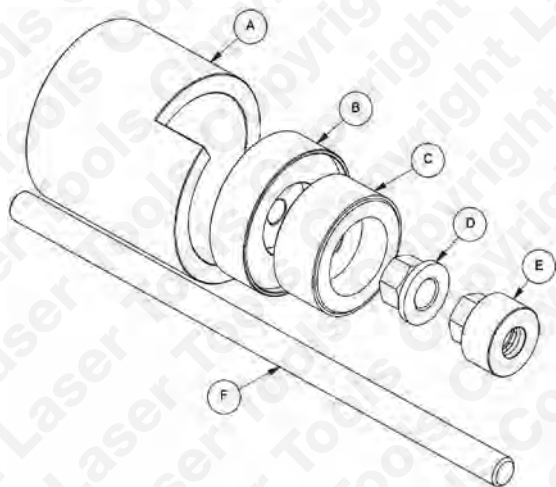

Ref.	Description	Replacement Part No.
A	Receiver Cup	
B	Insertion Force Cup	
C	Removal Force Cup	
D	M12 x 2mm Flange Nut	
E	M12 x 2mm Nut Assembly	1803
F	Force Screw	1319

- Always apply Molybdenum Disulphide grease to the force screw thread prior to assembling the kit and before screwing on the force screws.
- Always ensure the new bush is correctly aligned in all direction including radial positioning.
- Always replace the swing arm bushes as a pair.
- Replace bushes one at a time but only tighten the centre bolts with the weight on the wheels.
- Remove centre bush bolt and pull the arm down clear of the mounting.
- Lock in place with suitable block or strap

Applications

Marque	Model	Year
Ford	Fiesta VI	2008 - 2017

Instructions

The following instructions are for guidance only. Please refer to OEM derived data such as the vehicles manufacturers own data or Autodata.

The use of this tool is purely down to the user's discretion and The Tool Connection Ltd. cannot be held responsible for any damage caused what so ever.

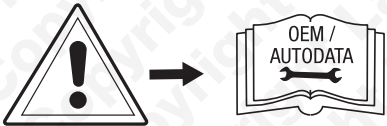

Extraction

- Before extraction mark the suspension arm to bush orientation to ensure the new bush is correctly aligned
- Apply grease to the force screw
 - Assemble as shown so that the bush is extracted toward the outside of the vehicle.

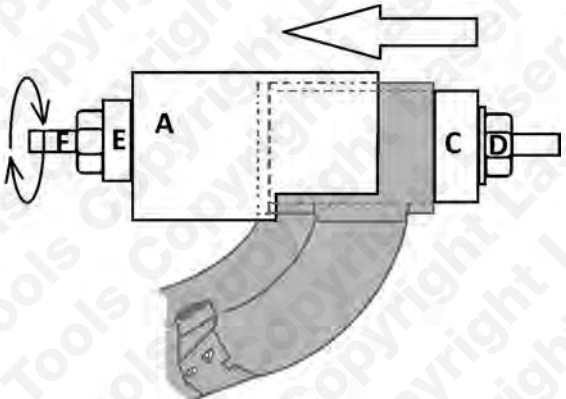

Insertion

- It is important the bush is correctly aligned. Align new bush to the marks made before extraction. Ensure the bush eye is clean and free from rust apply a small amount of petroleum jelly or similar around the new bush to aid insertion.
- Apply grease to the force screw
 - Assemble as shown so that the bush is inserted from the outside of the vehicle.

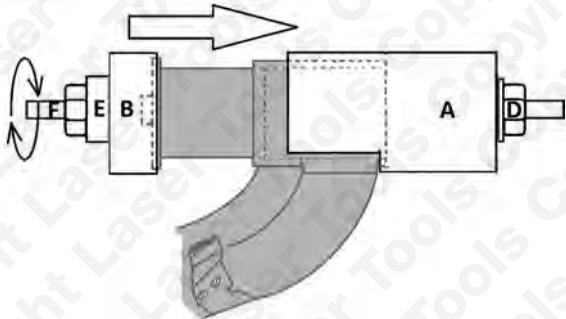

Our products are designed to be used correctly and with care for the purpose for which they are intended. No liability is accepted by the Tool Connection for incorrect use of any of our products, and the Tool Connection cannot be held responsible for any damage to personnel, property or equipment when using the tools. Incorrect use will also invalidate the warranty.

If applicable, the applications database and any instructional information provided has been designed to offer general guidance for a particular tool's use and while all attention is given to the accuracy of the data no project should be attempted without referring first to the manufacturer's technical documentation (workshop or instruction manual) or the use of a recognised authority such as Autodata.

It is our policy to continually improve our products and thus we reserve the right to alter specifications and components without prior notice. It is the responsibility of the user to ensure the suitability of the tools and information prior to their use.



Safety First. Be Protected.



When you have finished with this toolset please recycle it

www.lasertools.co.uk



Distributed by The Tool Connection Ltd
Kineton Road, Southam, Warwickshire CV47 0DR
T +44 (0) 1926 815000 F +44 (0) 1926 815888
info@toolconnection.co.uk www.toolconnection.co.uk

Guarantee

If this product fails through faulty materials or workmanship, contact our service department direct on: **+44 (0) 1926 818186**. Normal wear and tear are excluded as are consumable items and abuse.

6847_Instructions_v5

www.lasertools.co.uk