

Part No. 7066

# LASER<sup>®</sup>

## Engine Timing Tool Kit Vauxhall/Opel 1.3 CDTi

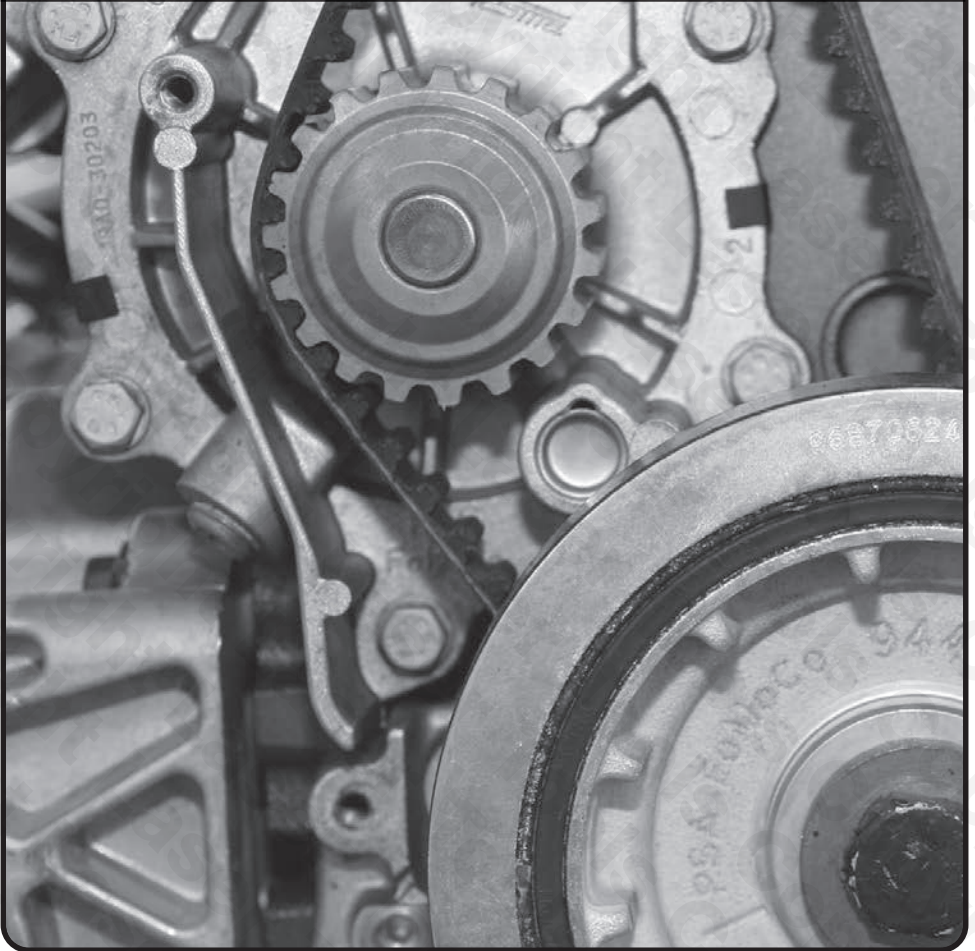

[www.lasertools.co.uk](http://www.lasertools.co.uk)

## Introduction

This engine timing kit offers the tools required to set, adjust and check the engine timing on the latest 1.3 CDTi diesel engines from Vauxhall/Opel.

NB: Where the camshafts require removal from the cylinder head additional tooling will be required - Part No. 7067.

## Plan Layout

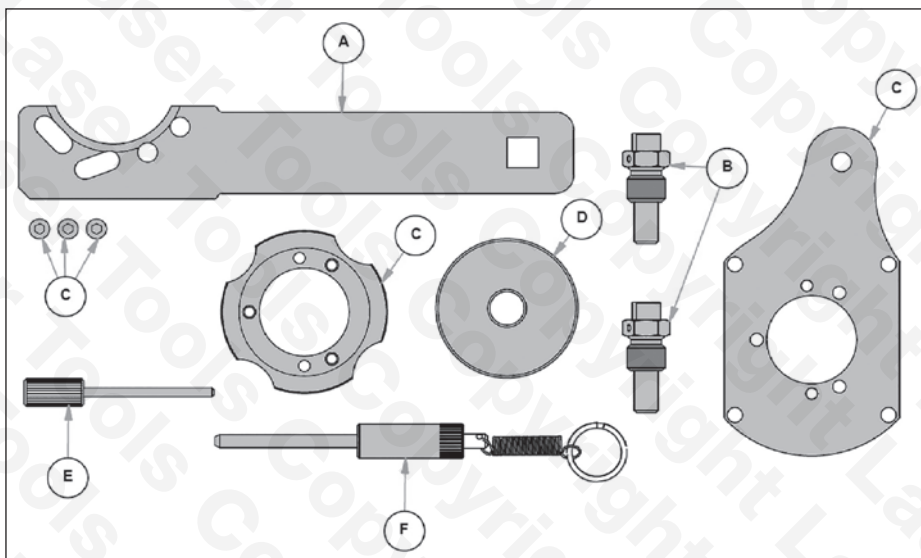

Ref.	Comp. Code	OEM Ref.	Description
A	C830	KM-662-C	Crankshaft Pulley Hub Holding Tool
B	C279	EN-50515	Camshaft Locking Tools (2)
C	C831	EN-51500	Camshaft Position Sensor Disc Setting tool
D	C832	EN-46775	Timing Chain Front Cover Aligning Tool
E	C178	KM-955-1	Timing Chain Tensioner Locking Pin
F	C276	EN-46785	Crankshaft Pin

## Applications

Make, Model, Year			Engine Codes
Vauxhall/Opel	Corsa-E 1.3 CDTi	2015 - 2017	LKU/B13DTE LKU/B13DTR LKV/B13DTC

Always refer to the website for most up to date applications:  
[www.lasertools.co.uk/product/7066](http://www.lasertools.co.uk/product/7066)

## Instructions

The following instructions are for guidance only. Please refer to OEM derived data such as the vehicle manufacturers' own data or Autodata.

The use of this engine timing tool kit is purely down to the user's discretion and The Tool Connection Ltd. cannot be held responsible for any damage caused whatsoever.

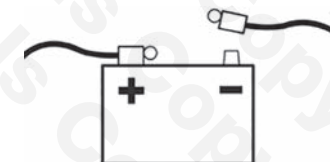

### Where Used:

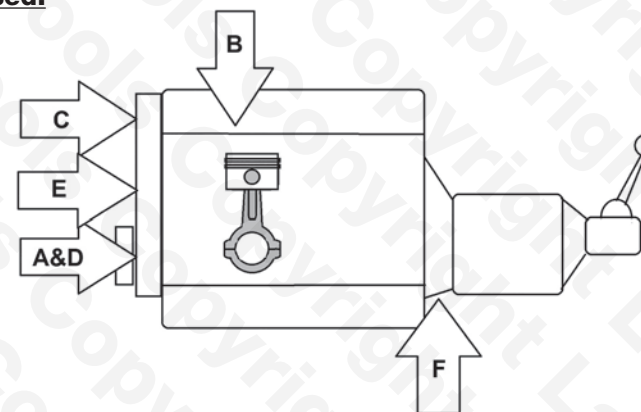

## Instructions

### Preparation

- Disconnect the battery
- Remove the glow plugs
- Remove engine sump

NB: Always turn the engine in normal direction of rotation.  
Do not use timing tools to torque or loosen fixings against unless otherwise stated.

### Component Descriptions:

#### Component A – Crankshaft Pulley Hub Holding tool

Used to hold the crankshaft pulley hub while undoing the hub fixings.  
Replace crankshaft bolt.

NB: Check thread direction before removal/fitting.

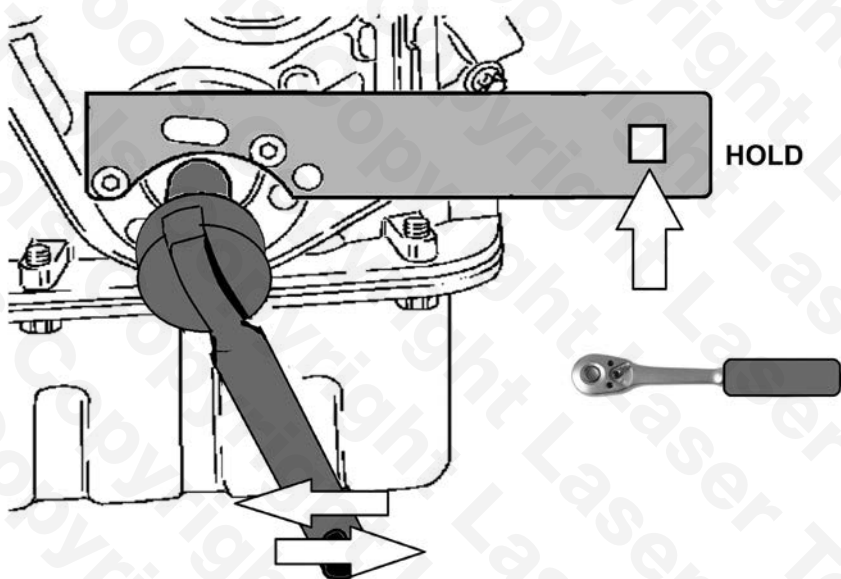

## Instructions

### Component B – Camshaft Locking Tools x 2

Used to set the camshaft timing. Remove the blanking plugs in the cylinder head and insert both the camshaft timing tools. Turn the camshaft until both tool centres can be pushed in.

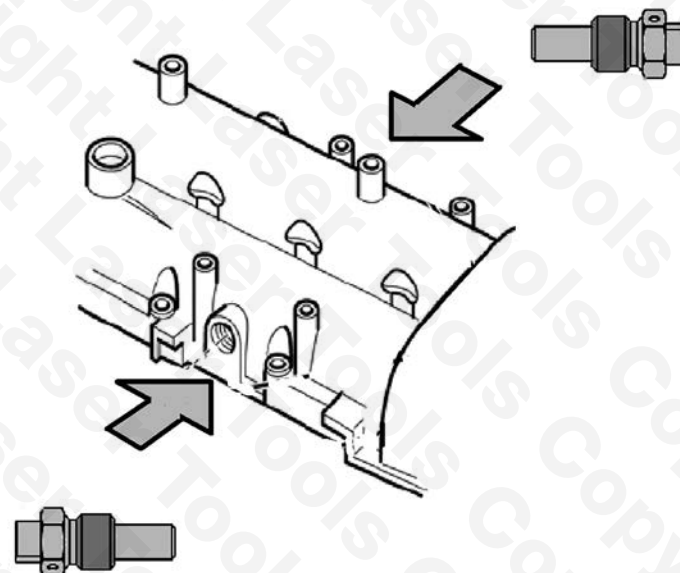



## Instructions

### **Component C – Camshaft Position Sensor Disc setting Tool**

Used to align and hold the camshaft in its correct position while the camshaft sprocket is tightened to the correct torque.

See OEM data for tightening torques.

Assemble and fit the holding tool as shown on the chain drive end of the camshaft.

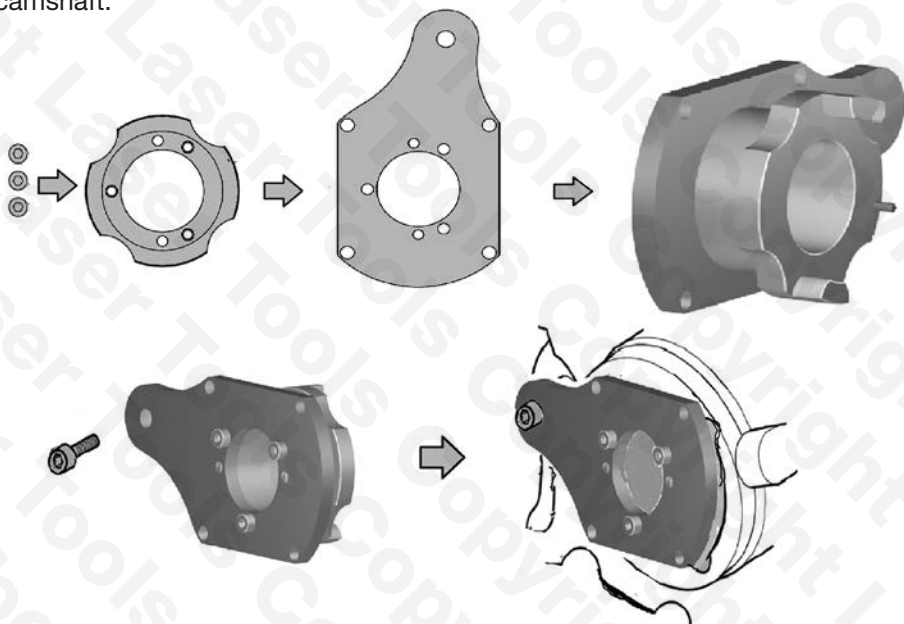

### **Component D – Front Cover alignment tool**

Used to align the front crankshaft oil seal and front engine cover.

If using original oil seal use component D to align the cover/seal assemble before tightening the cover bolt.

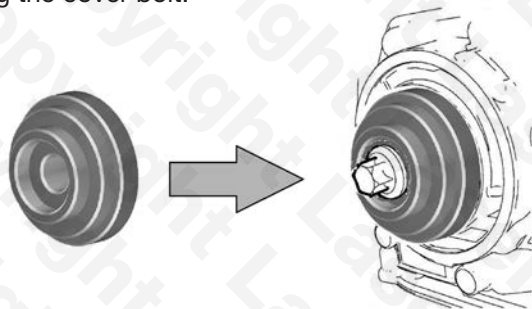

## Instructions

### **Component E – Timing Chain Tensioner Locking Pin**

Used to lock the tensioner in its retracted position, push the tensioner piston in and fit pin as shown.

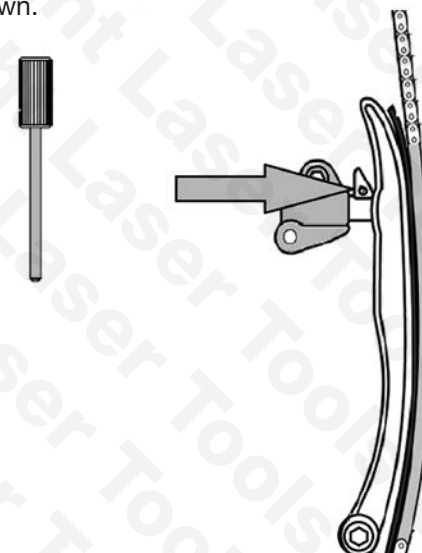

### **Component F – Crankshaft Timing Pin**

Used to lock the crankshaft via the bellhousing as shown.

For 5 speed transmission fit F in position X.

For 6 speed transmission fit F in position Y.

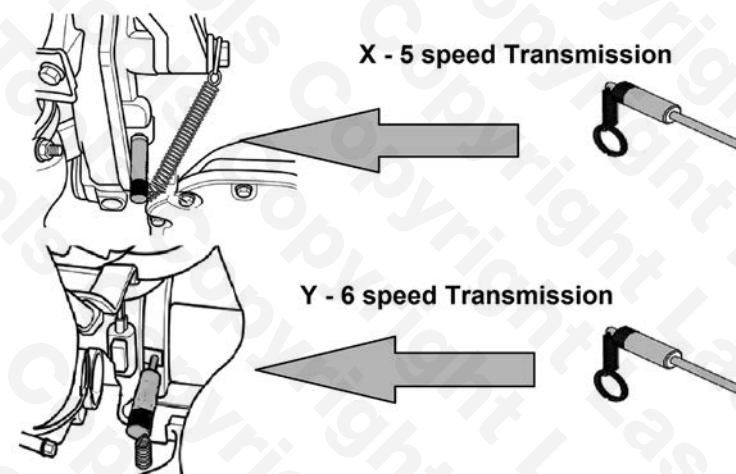

## Safety Precautions – Please read

- Disconnect the battery earth leads (check radio code is available)
- Remove spark or glow plugs to make the engine turn easier
- Do not use cleaning fluids on belts, sprockets or rollers
- Always make a note of the route of the auxiliary drive belt before removal
- Turn the engine in the normal direction (clockwise unless stated otherwise)
- Do not turn the camshaft, crankshaft or diesel injection pump once the timing chain has been removed (unless specifically stated)
- Do not use the timing chain to lock the engine when slackening or tightening crankshaft pulley bolts
- Do not turn the crankshaft or camshaft when the timing belt/chain has been removed
- Mark the direction of the chain before removing
- It is always recommended to turn the engine slowly, by hand and to re-check the camshaft and crankshaft timing positions
- Crankshafts and camshafts may only be turned with the chain drive mechanism fully installed
- Do not turn crankshaft via camshaft or other gears
- Check the diesel injection pump timing after replacing the chain
- Observe all tightening torques
- Always refer to the vehicle manufacturers' service manual or a suitable proprietary instruction book
- Incorrect or out of phase engine timing can result in damage to the valves

Our products are designed to be used correctly and with care for the purpose for which they are intended. No liability is accepted by the Tool Connection for incorrect use of any of our products, and the Tool Connection cannot be held responsible for any damage to personnel, property or equipment when using the tools. Incorrect use will also invalidate the warranty.

If applicable, the applications database and any instructional information provided has been designed to offer general guidance for a particular tool's use and while all attention is given to the accuracy of the data no project should be attempted without referring first to the manufacturer's technical documentation (workshop or instruction manual) or the use of a recognised authority such as Autodata.

It is our policy to continually improve our products and thus we reserve the right to alter specifications and components without prior notice. It is the responsibility of the user to ensure the suitability of the tools and information prior to their use.



7066\_Instructions\_V2



[www.lasertools.co.uk](http://www.lasertools.co.uk)



Distributed by The Tool Connection Ltd  
Kington Road, Southam, Warwickshire CV47 0DR  
T +44 (0) 1926 815000 F +44 (0) 1926 815888  
info@toolconnection.co.uk [www.toolconnection.co.uk](http://www.toolconnection.co.uk)

### Guarantee

If this product fails through faulty materials or workmanship, contact our service department direct on: **+44 (0) 1926 815186**. Normal wear and tear are excluded as are consumable items and abuse.

[www.lasertools.co.uk](http://www.lasertools.co.uk)