

Our products are designed to be used correctly and with care for the purpose for which they are intended. No liability is accepted by the Tool Connection for incorrect use of any of our products, and the Tool Connection cannot be held responsible for any damage to personnel, property or equipment when using the tools. Incorrect use will also invalidate the warranty.

If applicable, the applications database and any instructional information provided has been designed to offer general guidance for a particular tool's use and while all attention is given to the accuracy of the data no project should be attempted without referring first to the manufacturer's technical documentation (workshop or instruction manual) or the use of a recognised authority such as Autodata.

It is our policy to continually improve our products and thus we reserve the right to alter specifications and components without prior notice. It is the responsibility of the user to ensure the suitability of the tools and information prior to their use.



Safety First. Be Protected.

7079_Instructions_V1

Guarantee

This item contains consumable elements and are NOT covered by the Tool Connection Guarantee. For spares contact our service department direct on: +44 (0) 1926 818186.



Distributed by The Tool Connection Ltd

Kineton Road, Southam, Warwickshire CV47 0DR
T +44 (0) 1926 815000 F +44 (0) 1926 815888
info@toolconnection.co.uk www.toolconnection.co.uk



5 018341 070793 >

LASER[®]

7079

Brake Servo Release Tool Volkswagen

Instructions

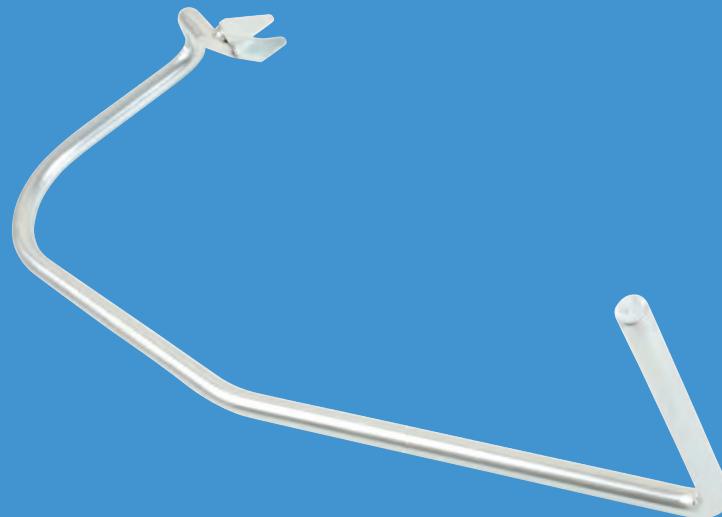

www.lasertools.co.uk

www.lasertools.co.uk

7079 VAG Brake Servo Pushrod Release Tool

This tool is designed to reach behind the brake pedal and release the servo pushrod from its retaining clip.

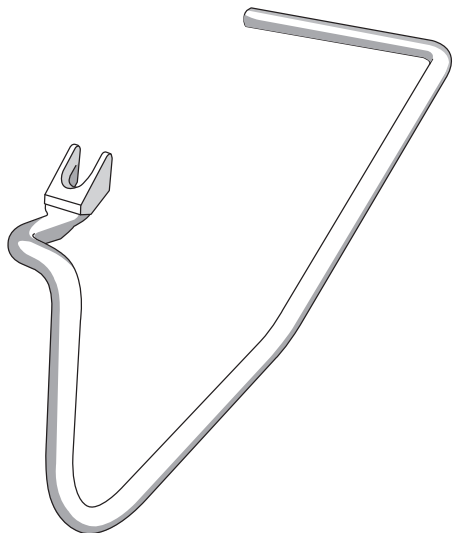

Applications

VW Passat 2016-2016; VW Phaeton

Instructions

1. Refer to diagram below.
2. Press brake pedal down and hold firmly, then insert release tool 7079 and pull away from pedal.
3. This action will push back the retaining lugs on the securing clip and release the ball-end of the pushrod.

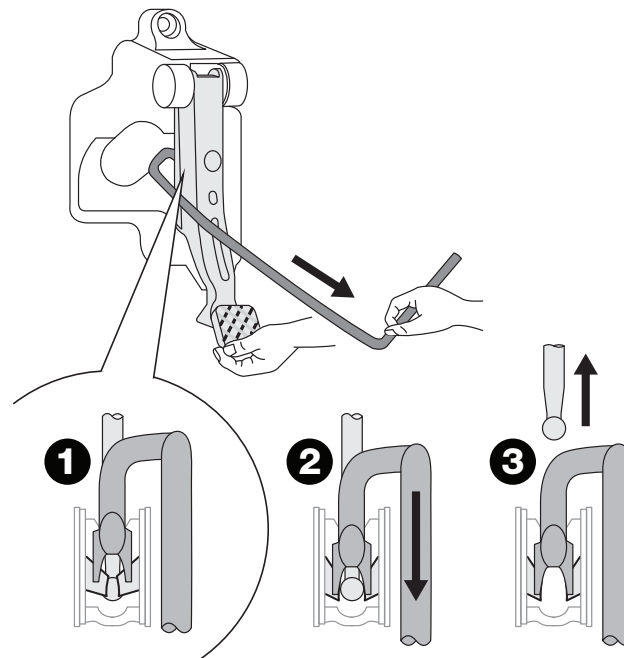

Reassembly

1. Hold ball-end of pushrod in front of the securing clip and push the brake pedal down so that the ball-end clicks into place.
2. Check engagement by pulling/pushing on brake pedal.