

Our products are designed to be used correctly and with care for the purpose for which they are intended. No liability is accepted by the Tool Connection for incorrect use of any of our products, and the Tool Connection cannot be held responsible for any damage to personnel, property or equipment when using the tools. Incorrect use will also invalidate the warranty.

If applicable, the applications database and any instructional information provided has been designed to offer general guidance for a particular tool's use and while all attention is given to the accuracy of the data no project should be attempted without referring first to the manufacturer's technical documentation (workshop or instruction manual) or the use of a recognised authority such as Autodata.

It is our policy to continually improve our products and thus we reserve the right to alter specifications and components without prior notice. It is the responsibility of the user to ensure the suitability of the tools and information prior to their use.



Safety First. Be Protected.

Guarantee

If this product fails through faulty materials or workmanship, contact our service department direct on: **+44 (0) 1926 818186**. Normal wear and tear are excluded as are consumable items and abuse.



Distributed by The Tool Connection Ltd

Kineton Road, Southam, Warwickshire CV47 0DR
T +44 (0) 1926 815000 F +44 (0) 1926 815888
info@toolconnection.co.uk www.toolconnection.co.uk

7131_Instructions_V1



LASER[®]

7131

Ball Joint Separator HGV 39mm



- Designed to fit LGV and HGV sized ball joints. Supplied with 3 different length pressure pieces and a threaded adaptor to allow the use of a hydraulic ram
- Designed to cover as many sizes as possible in one tool.

www.lasertools.co.uk

www.lasertools.co.uk

Components

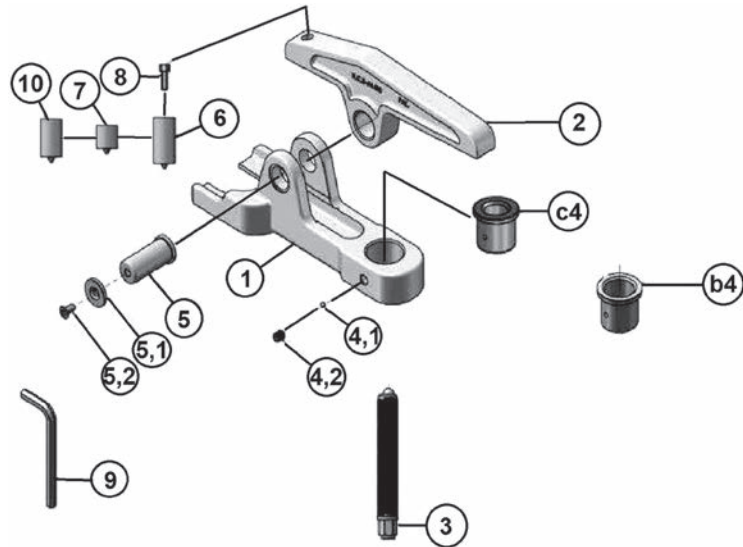

| Ref | Description |
|-----|--|
| 1 | Main Body |
| 2 | Main lever |
| 3 | Force screw M24 x 3.0mm (spare available - Part No. 60439) |
| B4 | 1 1/2" x 16TPi UNF (for 5654 available separately) |
| C4 | M24 x 3mm Threaded adaptor (for 3) |
| 4,1 | Locking ball |
| 4,2 | Grub Screw |
| 5 | Lever Pivot Pin |
| 5,1 | Lever Pivot Pin Holding Washer |
| 5,2 | Fixing Screw |
| 6 | Pressure Piece (long) |
| 7 | Pressure Piece (short) |
| 8 | Pressure Piece Fixing Screw (5mm Hex) |
| 9 | Hex Key 5mm (for 8) |
| 10 | Pressure Piece (medium) |

The following instructions are for guidance only

The use of this Ball Joint Separator is purely down to the user's discretion and The Tool Connection Ltd. cannot be held responsible for any damage caused what so ever.



Instructions

- Assemble as follows according to the size of the joint to be separated.
- Try to ensure that the angle between the force screw (3) and the lever (2) as closed to 90 degrees as possible to ensure the max force is applied.
- Ensure the force screw is lubricated with Molybdenum Disulphide Grease.
- Force screws are easily damaged if not lubricated. Components 3 and C4 are considered consumable.
- Assemble as shown below selecting the most suitable length pressure piece to give the appropriate angle at the force screw as the load come on.

SET UP:

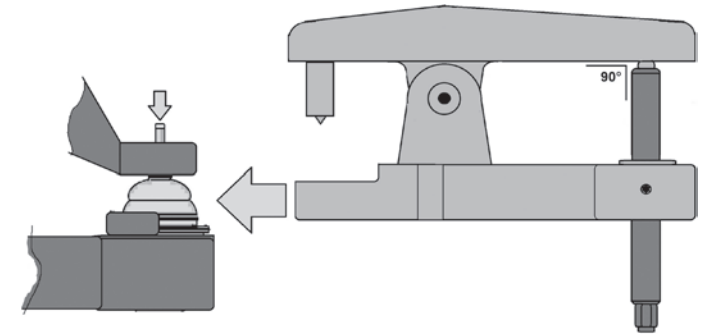

MECHANICAL SCREW ASSEMBLY:

- Using the force screw and a suitable wrench wind on the load. With load applied using a mallet sharply tap the end of the force screw (3) to help shock the joint free.

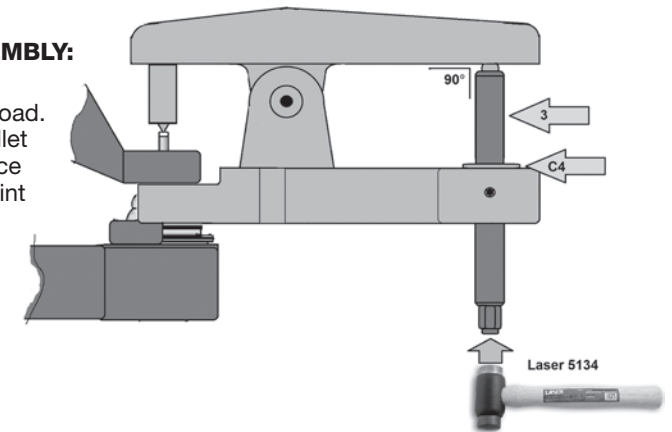

Hydraulic Ram Assembly

(Laser 5654 available separately):

