

Our products are designed to be used correctly and with care for the purpose for which they are intended. No liability is accepted by the Tool Connection for incorrect use of any of our products, and the Tool Connection cannot be held responsible for any damage to personnel, property or equipment when using the tools. Incorrect use will also invalidate the warranty.

If applicable, the applications database and any instructional information provided has been designed to offer general guidance for a particular tool's use and while all attention is given to the accuracy of the data no project should be attempted without referring first to the manufacturer's technical documentation (workshop or instruction manual) or the use of a recognised authority such as Autodata.

It is our policy to continually improve our products and thus we reserve the right to alter specifications and components without prior notice. It is the responsibility of the user to ensure the suitability of the tools and information prior to their use.

LASER®

Engine Timing Tool Kit VAG / Porsche TFSI / FSI

Engine applications: 2.5 FSI, 2.8 FSI, 3.0 TFSI, 3.2 FSI.

Audi: A4 (2014 to 2015), A5 (2014 to 2017), A6 (2012 to 2018), A7 (2010 to 2018), A8 (2010 to 2018), S4 (2014 to 2017), S5 (2011 to 2017), Q5 (2008 to 2017), Q7 (2010 to 2018), SQ5 (2013 to 2017).

Volkswagen: Touareg 3.0 TFSI (2012 to 2017).

Porsche: Cayenne S Hybrid (2010 to 2014), Panamera (2011 to 2013).

Equivalent to OEM tools T40133/1/2, T40058, T40069, T40071. Use in accordance with OEM instructions only.

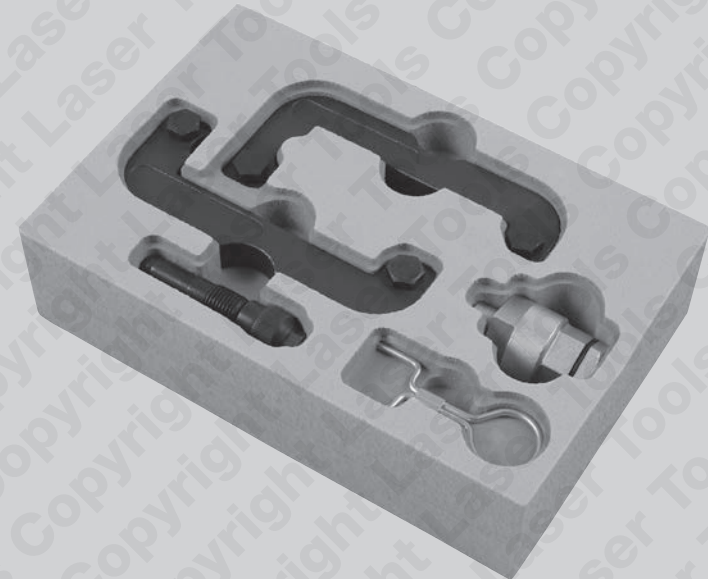

7549_INSTRUCTIONS_V6

Guarantee

If this product fails through faulty materials or workmanship, contact our service department direct on: **+44 (0) 1926 818186**. Normal wear and tear are excluded as are consumable items and abuse.



Distributed by The Tool Connection Ltd

Kineton Road, Southam, Warwickshire CV47 0DR
T +44 (0) 1926 815000 F +44 (0) 1926 815888
info@toolconnection.co.uk www.toolconnection.co.uk



7549 Timing Tool Set

VAG & Porsche 2.5, 2.8, 3.0, 3.2 TFSI/FSI

This Engine Timing Kit provides the tools required to lock the camshaft and crankshaft of the engines listed in their “timed” position, allowing the camshaft drive chains to be removed and the timing set or checked.

Note: Use in accordance with OEM instructions only.

Ref	Laser	OEM	Description
A	C912	T40133/1	CAM LOCKING TOOL
B	C912	T40133/2	CAM LOCKING TOOL
C	C395	T40058	CRANKSHAFT PULLEY BOLT ADAPTOR TOOL
D	C357	T40069	CRANKSHAFT TIMING PIN
E	C358	T40071	TENSIONER PINS

The following instructions are for guidance only. Please refer to OEM derived data such as the vehicles manufactures own data or Autodata.

The use of this engine timing tool kit is purely down to the user's discretion and The Tool Connection Ltd cannot be held responsible for any damage caused whatsoever.

Applications

MAKE, MODEL, YEAR.				ENGINE CODE		
Audi	A4	2011 to 2015	TFSI	2.5	CGXB	CMDA
	A5	2007 to 2017	Hybrid S	CLXB	CHMA	CJTB
	A6	2007 to 2018	S Hybrid	CPAA	CTTA	CJTC
	A7	2010 to 2018	FSI	2.8	CTUA	CJWC
	A8	2010 to 2018		CHVA	CTVA	CAKA
	Q7	2010 to 2018		CNYA	CNAA	CGXC
	S4	2009 to 2017		BDX	CTWA	M06/EC
	S5	2010 to 2017		CCDA	CTWB	CGEA
	Q5	2008 to 2017		CCEA	CGWC	CJTA
	SQ5	2013 to 2018		CJBA	CTUD	CGFA
Porsche	Cayenne	2010 to 2014		3.0	CTXA	3.2
	Panamera	2011 to 2013		CRED	CMUA	CALA
Volkswagen	Touareg	2010 to 2014		CREC	CAJA	CALB
				CREA	CCAA	
				CHMB	CGWB	
				CGWD	CGWA	

Note:

Ensure the engine timing marks are aligned as per OEM instructions

Set timing @ TDC number one cylinder ensuring the threaded holes through the camshafts face up.

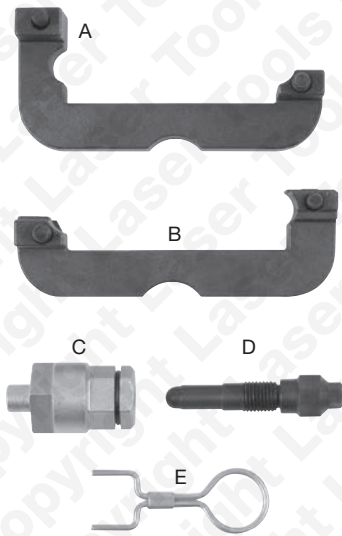

Component A & B

Fit the cam locking tools, as shown in Fig:1

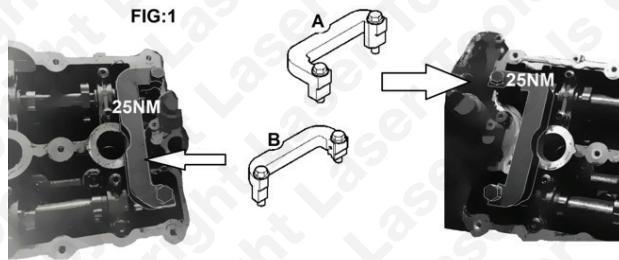

Components C:

Component C is used to turn the crankshaft to the set point, as shown in Fig:2

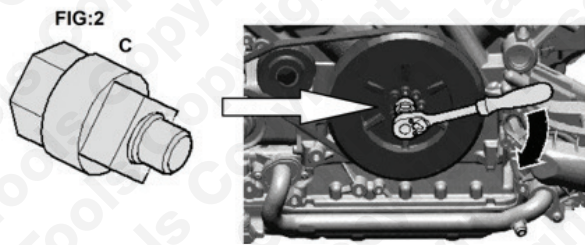

Component D:

Fit Crankshaft timing pin as shown in place of the blanking plug in the upper sump, as shown in Fig:3

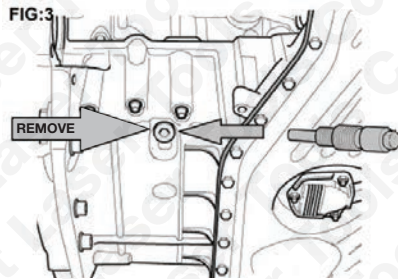

Component E:

Use component E to lock the camshaft chain tensioners, as shown in Fig:4.

