

Part No. 7910

LASER[®]

Laser Alignment & Spirit Level Tool

Instructions



www.lasertools.co.uk

Features

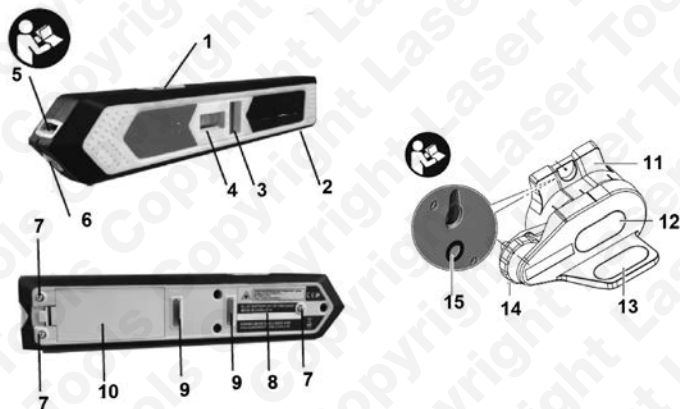

Ref.	Description
1	On / Off Slide Switch with Operating-mode Selector
2	Aluminium Supporting Surface
3	Spirit Level for Vertical Alignment
4	Spirit Level for Horizontal Alignment
5	Laser Outlet Opening for Line Operation
6	Laser Outlet Opening for Point Operation
7	Supporting Points
8	Laser Warning Label
9	Magnets
10	Battery Lid
11	Wall Holder
12	Metal Surface for Line Operation
13	Metal Surface for Point Operation
14	Adjusting Screw of Wall Holder
15	1/4" Universal Tripod Mount

Instructions

Assembly

Inserting/Replacing the Batteries

This product requires 2 x AAA batteries.

To open the battery lid (10), open the latch (A) and open the door in the direction shown (see figure 1). Insert the batteries provided, as illustrated in the battery compartment.

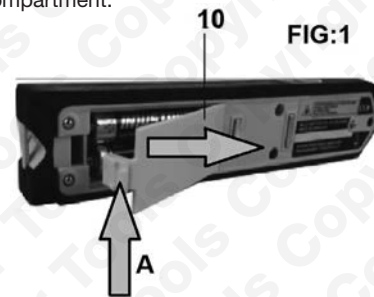

Always replace all batteries at the same time. Only use batteries from one brand and with the identical capacity.

Remove the batteries from the measuring tool when not using it for extended periods. When storing for extended periods, the batteries can corrode and self-discharge.

Operation

Initial Operation

- Protect the measuring tool against moisture and direct sun light.
- Do not subject the measuring tool to extreme temperatures or variations in temperature. As an example, do not leave it in vehicles for long periods in direct sunlight. In case of large temperature variations, allow the measuring tool to adjust to the ambient temperature before putting it into operation.
- Avoid shock and impact. Shock damage to the measuring tool can impair its accuracy.
- Switch the measuring tool off during transport.

Introduction

Switching On and Off

To switch on the measuring tool in line operation, push the On/Off switch (1) forward. To switch on the measuring tool in point operation, push the On/Off switch (1) back.

Immediately after switching on, the measuring tool sends a laser beam out of outlet opening (5 line operation) or (6 point operation), depending on the selected operating mode.

WARNING: Do not point the laser beam at persons or animals and do not look into the laser beam yourself.

To switch off the measuring tool, push the On/Off switch (1) to the centre position.

Do not leave the switched-on tool unattended and switch the tool off after use.

For best battery life always switch off the measuring device when not in use.

Levelling Functions

NOTE: The specified levelling accuracy applies for the alignment of the laser beam with reference to the spirit levels (3 and 4).

If spirit levels (3 or 4) leak, soak up with appropriate absorbent material and dispose of safely. Spirit levels contain flammable liquid that may cause respiratory tract, eye and skin irritation.

Position the Tool (see figure 2)

FIG:2

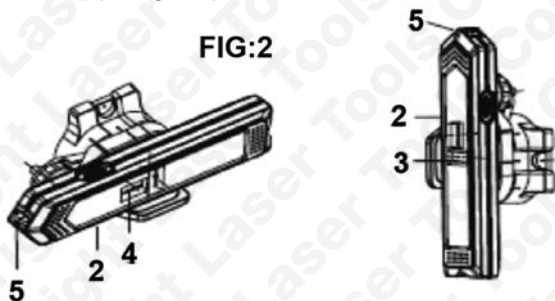

Instructions

For precise alignment using the spirit levels, the position of the tool is important. The specified levelling accuracy is only achieved when the tool is correctly positioned.

For horizontal alignment with spirit level (4): the laser outlet opening for line operation (5) must be horizontal and the aluminium supporting surface (2) of the measuring tool must face downward.

For vertical alignment with spirit level (3): the laser outlet opening for line operation (5) must face upward and the aluminium supporting surface (2) of the measuring tool must face sideward.

Alignment with Laser Line (Line Operation)

Fasten the measuring tool to wall holder (11), place it against a wall or flat surface being used as datum via the three supporting points (7) or fasten it to another magnetic surface with the magnets (9).

Note: Horizontal alignment with the laser line is only possible on the surface against which the measuring tool was placed. Even when the measuring tool was aligned with the spirit level, the laser line on a transverse wall does not necessarily run horizontal, and is thus not suitable for levelling.

Vertical Alignment: The laser outlet opening for line operation (5) must face upward and the aluminium supporting surface (2) of the measuring tool must face sideward.

Vertically align the measuring tool with spirit level (3). As an example, you can align top and base cabinets alongside the vertical laser line.

Alignment of reference points: Turn the measuring tool to any required angle in order to align the laser line alongside your reference points. As an example, this can be used to place vehicle moulding in relation to other moulding or body points.

Projecting/Checking Heights via Laser point (Point Operation)

Place the measuring tool on the wall holder and horizontally align it. As an example, you can use the laser point to align mouldings, stickers etc. to a set height.

When turning, do not touch the measuring tool, otherwise its position could be changed.

Introduction

Working with tripod (recommended): Align the laser beam to the requested height.

Project or check the height at the target location.

Vehicle wheel alignment (Use with Gunson 77137 or 77141).

Horizontally align the measuring tool with spirit level (4).

Example 1: Checking initial alignment of the front wheel to the rear axle after centralising the steering rack/box and prior to checking the tracking.

Example 2: Checking initial alignment of the rear wheels/axle to the front wheels prior to setting the front tracking.

Checking Horizontal / Vertical Lines with the Spirit Levels

The measuring tool can also be used as a carpenter's spirit level for checking vertical and horizontal lines, for example to align a washing machine or a refrigerator. Position the measuring tool with the aluminium supporting surface (2) on the surface to be checked. When placing on horizontal surfaces, the aluminium supporting surface (2) must face downward, when placing against vertical surfaces, the laser outlet opening for line operation (5) must face upward.

Working Advice

For marking out, always use the centre of the laser point or the laser line. The size of the laser point as well as the width of the laser line will change with distance.

Fastening/aligning with the wall holder: With the wall holder (13), the measuring tool can be fastened as follows: **Line operation:** Place the wall holder via its recess on the backside onto a screw head slightly projecting out of a wall. Fasten the measuring tool with the magnets (9) to the metal surface for line operation (12) of the wall holder. Turn the upper part of the wall holder to align the measuring tool as required.

Point operation: Place the wall holder via a tripod mount onto the 1/4" male thread of the tripod and screw the locking screw of the tripod tight. Align the tripod roughly. When working without tripod, place the wall holder on a surface that is as horizontal as possible. Position the measuring tool with the aluminium supporting surface (2) facing down

Instructions

on the wall holder. Attach it via the left magnet (9) (viewed from the front side of the measuring tool) to the metal surface for point operation (13) of the wall holder. Horizontally align the upper part of the wall holder with adjusting screw (14) of the wall holder and spirit level (4) of the measuring tool. Turn the upper part of the wall holder by 90° and repeat the alignment.

FIG:2

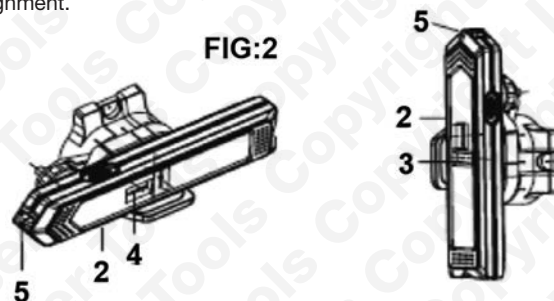

Maintenance and Service

Maintenance and Cleaning: Store and transport the measuring tool only in the supplied protective pouch. Keep the measuring tool clean at all times. Do not immerse the measuring tool in water or other fluids. Wipe off debris using a moist and soft cloth. Do not use any cleaning agents or solvents. Regularly clean the surfaces at the exit opening of the laser in particular, and pay attention to any fluff of fibres.

After-sales Service and Application Service: Our after-sales service responds to your questions concerning maintenance and repair of your product as well as spare parts.

Disposal: Measuring tools, accessories and packaging should be sorted for environmentally-friendly recycling. Do not dispose of measuring tools and batteries/rechargeable batteries into household waste.

Only for EC countries:

According to the European Guideline 2012/19/EU, measuring tools that are no longer usable, and according to the European Guideline 2006/66/EC, defective or used battery packs/batteries, must be collected separately and disposed of in an environmentally correct manner.

Our products are designed to be used correctly and with care for the purpose for which they are intended. No liability is accepted by the Tool Connection for incorrect use of any of our products, and the Tool Connection cannot be held responsible for any damage to personnel, property or equipment when using the tools. Incorrect use will also invalidate the warranty.

If applicable, the applications database and any instructional information provided has been designed to offer general guidance for a particular tool's use and while all attention is given to the accuracy of the data no project should be attempted without referring first to the manufacturer's technical documentation (workshop or instruction manual) or the use of a recognised authority such as Autodata.

It is our policy to continually improve our products and thus we reserve the right to alter specifications and components without prior notice. It is the responsibility of the user to ensure the suitability of the tools and information prior to their use.



7910_Instructions_V2



www.lasertools.co.uk



Distributed by The Tool Connection Ltd
Kington Road, Southam, Warwickshire CV47 0DR
T +44 (0) 1926 815000 F +44 (0) 1926 815888
info@toolconnection.co.uk www.toolconnection.co.uk

Guarantee

If this product fails through faulty materials or workmanship, contact our service department direct on: **+44 (0) 1926 818186**. Normal wear and tear are excluded as are consumable items and abuse.

www.lasertools.co.uk