

Part No. 8003

LASER[®]

Portable Vacuum Box Fluid Extraction

Instructions



www.lasertools.co.uk

Introduction

The Laser 8003 portable vacuum box is designed to extract fluids under vacuum — this is a lightweight, easily portable unit and once the vacuum has been generated with workshop compressed air, the unit can be carried to any location for one-man operation.

The vacuum box can be used to extract water, coolant, refrigerant, brake fluid and oils (engine oil, gearbox oil, compressor oil, etc). Can also be used for leak testing. Useful for vacuum brake bleeding and a brake bleed tube attachment is supplied. It must not be used to extract flammable liquids. Once connected to a workshop air supply, the venturi nozzle generates a vacuum of -0.7 bar. Built-in vacuum gauge and vacuum-relief / pressure valve.

Procedure

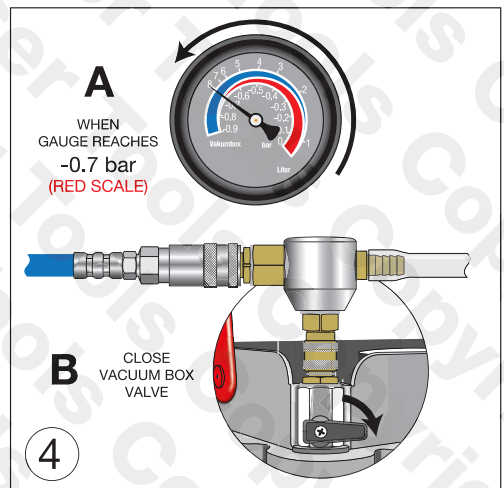
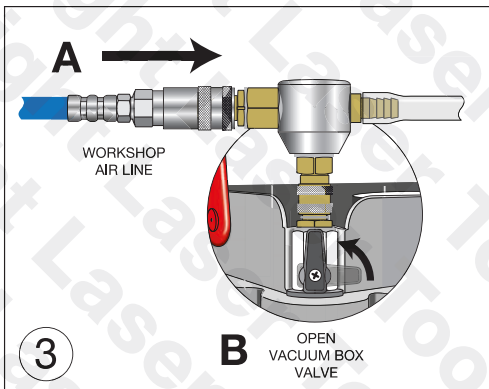
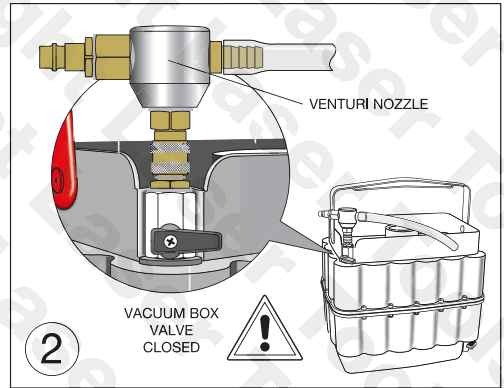
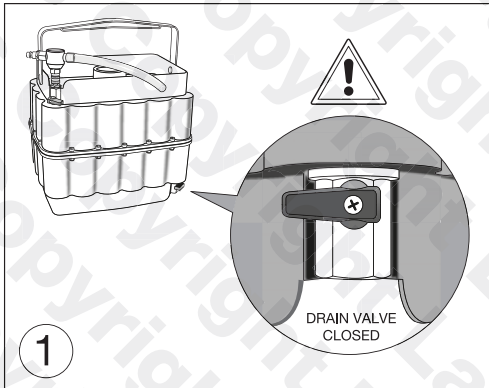

Procedure

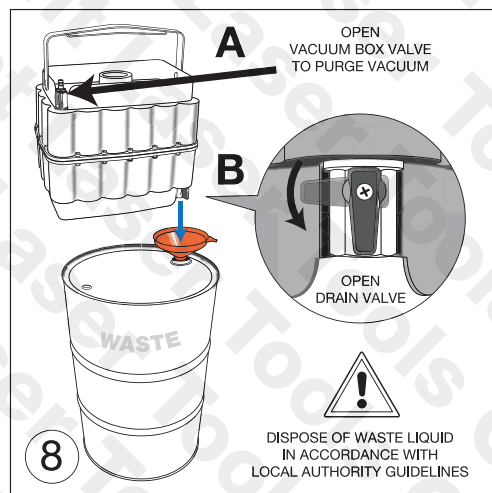
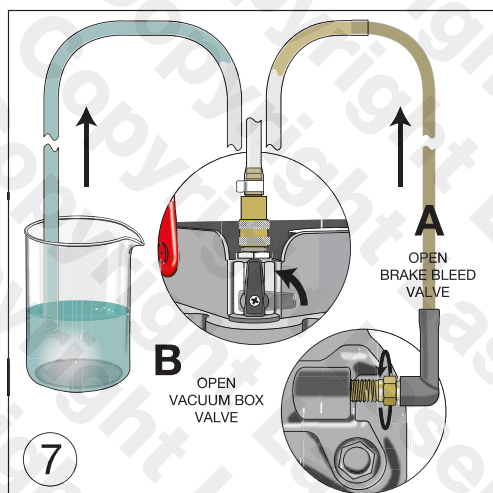
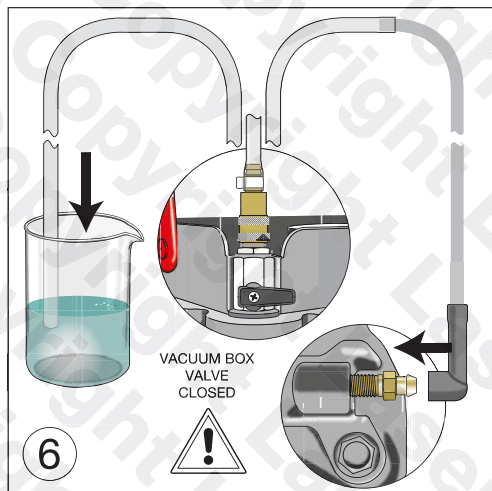
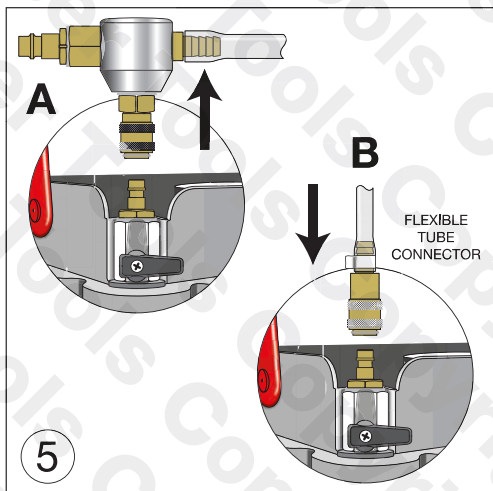

Specifications

Construction:	Impact-resistant plastic
Capacity:	7 litres (approximately) @ -.07 bar
Dimensions:	300 (L) x 200 (W) x 350mm (H)
Weight:	3.5kg
Extraction tube length:	1.5m
Extraction tube + brake bleed tube:	2.5m

Precautions

- Do not extract flammable liquids — EXPLOSION HAZARD!
- Do not extract acid or alkaline solutions.
- Do not connect the vacuum box directly to a compressed air supply. The vacuum box will be damaged beyond use and will not be covered under the warranty — the compressed air supply must be connected to the venturi nozzle only.
- Do not attempt to dismantle or open the vacuum box — the internal sealing paint will be compromised, the box will be damaged beyond use and will not be covered under the warranty.
- Do not let the vacuum generated exceed -0.7 bar — pay close attention to the vacuum gauge as the vacuum is being generated by the compressed air supply.
- On completing the process, empty the vacuum box (refer to Figure 8) by first opening the vacuum box valve (to purge the vacuum) then open the drain valve. Dispose of the waste fluid in accordance with local authority guidelines.



Our products are designed to be used correctly and with care for the purpose for which they are intended. No liability is accepted by the Tool Connection for incorrect use of any of our products, and the Tool Connection cannot be held responsible for any damage to personnel, property or equipment when using the tools. Incorrect use will also invalidate the warranty.

If applicable, the applications database and any instructional information provided has been designed to offer general guidance for a particular tool's use and while all attention is given to the accuracy of the data no project should be attempted without referring first to the manufacturer's technical documentation (workshop or instruction manual) or the use of a recognised authority such as Autodata.

It is our policy to continually improve our products and thus we reserve the right to alter specifications and components without prior notice. It is the responsibility of the user to ensure the suitability of the tools and information prior to their use.



8003_Instructions_V3



www.lasertools.co.uk

Guarantee



Distributed by The Tool Connection Ltd
Kington Road, Southern, Warwickshire CV47 0DR
T +44 (0) 1926 815000 F +44 (0) 1926 815888
info@toolconnection.co.uk www.toolconnection.co.uk

If this product fails through faulty materials or workmanship, contact our service department direct on: **+44 (0) 1926 818186**. Normal wear and tear are excluded as are consumable items and abuse.

www.lasertools.co.uk