

## Hybrid/EV Tool Cabinet Assembly Instructions

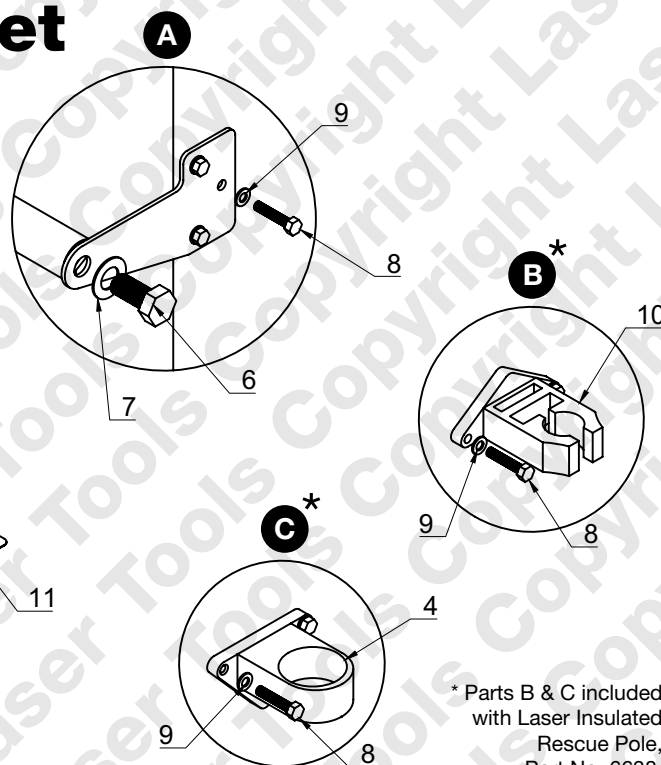

Screw-in by hand all components before tightening with appropriate tool.

†D (Part No. 7945) included with Laser cabinet 8490.

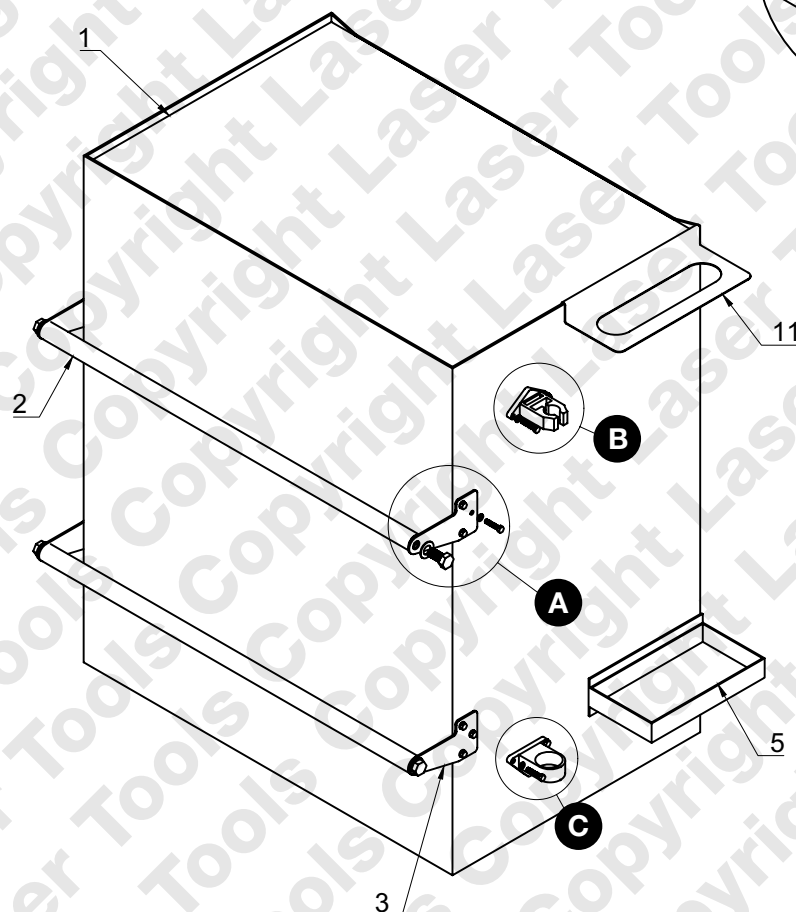
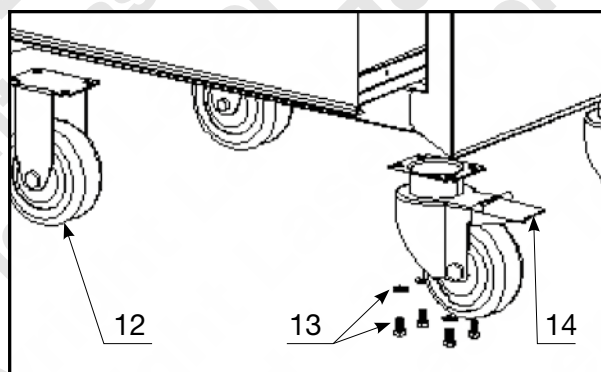
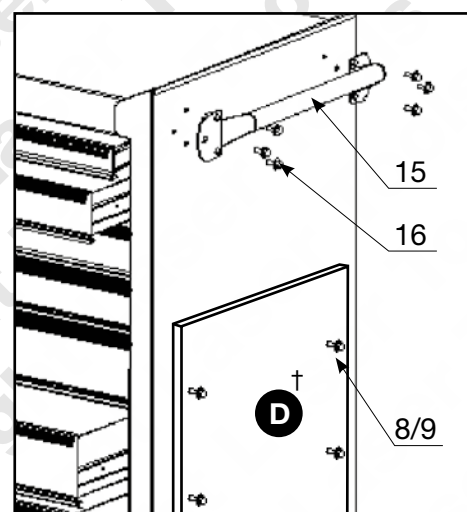

Ref.	Description	Qty
1	Roller cabinet	1
2	Base holder bar	2
3	Base holder bracket	4
4	Lower pole holder	1
5	Magnetic tray	1
6	M12 bolt	4
7	M12 washer	4
8	M5 bolt	20
9	M5 washer	20
10	Upper pole holder	1

Ref.	Description	Qty
11	Side posts holder	1
12	5" fixed caster	2
13	M8 hex bolt with washer	16
14	5" swivel caster with brake	2
15	Side handle	1
16	M6 x 16mm bolt	6