

LASER[®]

Differential Bush Removal & Installation Kit - for BMW

Instructions

- Designed to remove and fit both front & rear bushes on the rear differential.
- Applications include: BMW 1 Series (2004 - 2014), 3 Series (2005 - 2014), Z4 (2003 - 2009).
- BMW chassis references: E81, E82, E83, E84, E85, E86, E87, E88, E90, E91, E92, E93.
- Equivalent to OEM 33 3 312, 33 4 161, 33 4 162, 33 4 166, 33 4 311, 33 4 312, 33 42 81, 33 4 351, 33 4 357, 33 4 358, 33 4 465 and 33 4 466.

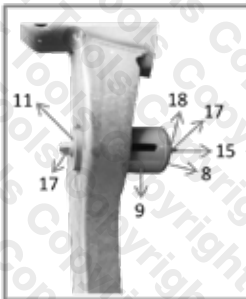

Removal-Rear

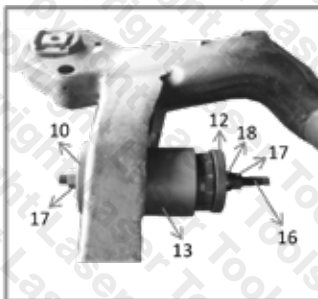

Installation- Rear

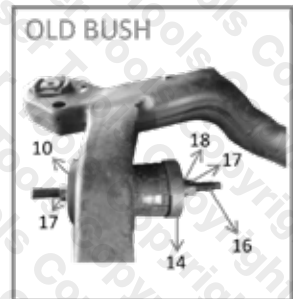

Installation- Rear

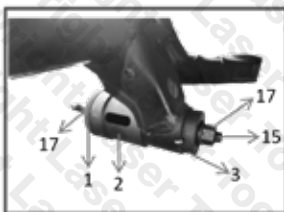

Removal-Front

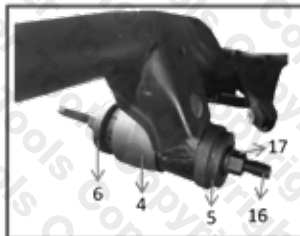

Installation-Front

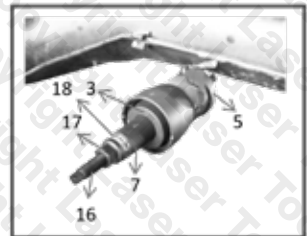

Installation-Front

Ensure all force screws are lubricated with molybdenum disulphide grease.
Use hand tools only.