

Part No. 8912

LASER[®]

Locking Wheel Nut Removal Kit – Lug Driller

Instructions



www.lasertools.co.uk

Introduction

Say goodbye to the challenge of lost or damaged locking wheel nut keys with the ultimate tool for the quick and safe removal of the most stubborn locking wheel nuts/bolts. Engineered for efficiency and safety, this tool is a game-changer for service centres, tyre fitting bays, and roadside recovery drivers. Convenient storage: all components are neatly organised in a blow-mould case, providing easy access and convenient storage for busy professionals on the go. *NOTE: drill required.*

Components



| Ref. | Description |
|------|---------------------------------------|
| 1 | Impact extractor-holder |
| 2 | Impact extractor-remover |
| 3 | Centring guide for free-turning bolts |
| 4 | External centring guide |
| 5 | External centring guide |
| 6 | External centring guide |

| Ref. | Description |
|------|-------------------------------|
| 7 | Ultra-hard drill (X 2) |
| 8 | Extractors (X 4) |
| 9 | Nylon internal centring guide |
| 10 | Nylon internal centring guide |
| 11 | Nylon internal centring guide |
| 12 | Nylon internal centring guide |

Instructions

To remove a damaged wheel nut or locking wheel nut:



Fig 2 CENTRING GUIDES

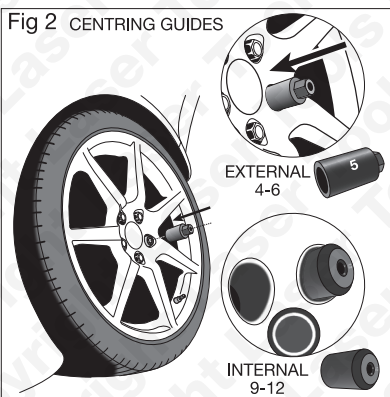

Fig 3 CENTRING GUIDES

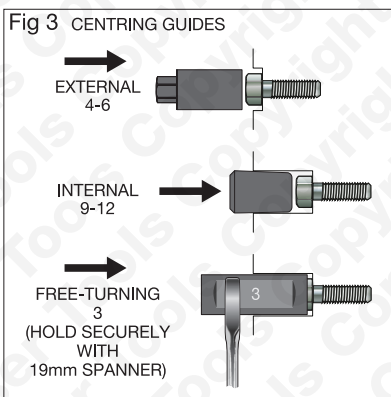

Fig 4

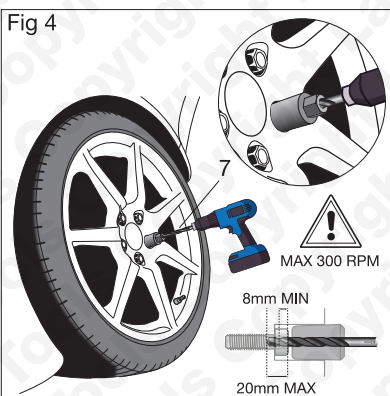

Fig 5

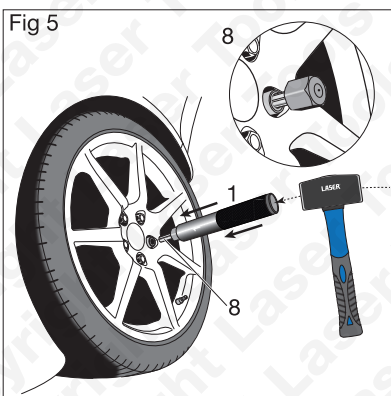

Fig 6

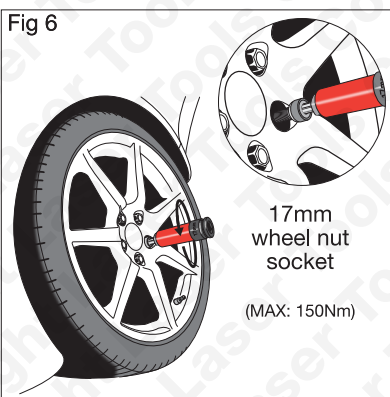
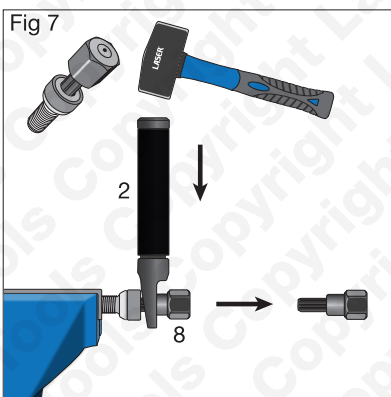

Fig 7



Precautions



- Eye and hand protection **MUST** be worn at all times, including protective workwear.
- Read and understand these instructions before use.
- Ensure the vehicle is in a safe, stable environment before using the wheel nut removal kit.
- Never use a component which is chipped, or damaged.
- In use, make sure the components and the hammer face are clean, e.g. free from oil, etc.
- Keep the tool components clean and well-maintained. Store in case when not in use.
- Items 7 and 8 are regarded as consumable and therefore not covered by standard warranty.

Our products are designed to be used correctly and with care for the purpose for which they are intended. No liability is accepted by the Tool Connection for incorrect use of any of our products, and the Tool Connection cannot be held responsible for any damage to personnel, property or equipment when using the tools. Incorrect use will also invalidate the warranty.



Safety First. Be Protected.



5 018341 089122 >



www.lasertools.co.uk



Distributed by The Tool Connection Ltd
Kineton Road, Southam, Warwickshire CV47 0DR
T +44 (0) 1926 815000 F +44 (0) 1926 815888
info@toolconnection.co.uk www.toolconnection.co.uk

Guarantee

If this product fails through faulty materials or workmanship, contact our service department direct on: **+44 (0) 1926 818186**. Normal wear and tear are excluded as are consumable items and abuse.

8912_Instructions_V1

www.lasertools.co.uk